

SSU 1-00 Scrub sink, single compartment

MODEL RANGE: HEALTHCARE | SSU 1-00

Special hospital equipment | Surgical scrub stations

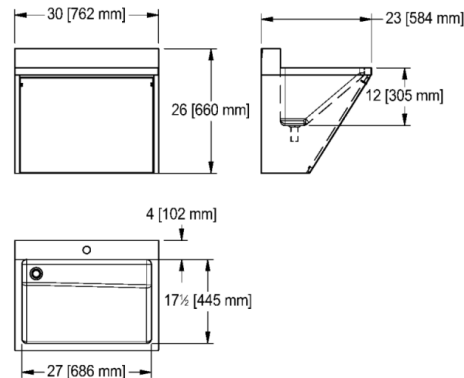

Single compartment surgical scrub station. 18 gauge (1.2 mm), type 304 (CNS 18/10) stainless steel. Polished #4 satin finish. Radius coved bowl corners. Franke hygienic waste with integral talipiece. (No separate waste fitting required) Access panel for service and maintenance. Supplied with wall hanger brackets. Certified to ASME A112.19.3-2008 / CSA B45.4-08. Faucet not included with base model, see below for options. Please specify hole drilling requirement when ordering.

Model Options:

SSU1-00-1
1 faucet hole, 1-1 / 2" diameter, centred over bowl

SSU1-10
AC powered hands-free faucet
MIX-LF, thermostatic mixing valve

SSU1-11
AC powered hands-free faucet
MIX-LF, thermostatic mixing valve
DC powered hands-free soap dispenser, Rodan RODX625

23 x 30" Overall. 17 1 / 2 x 27 x 12" Bowl. (FB x LR x D).
584 x 762 mm Overall. 445 x 686 x 305 mm Bowl. (FB x LR x D).

Technical data	
Bowl height	12 inch
Bowl depth	17 1 / 2 "
Bowl width	27 "
Overall depth	23 "
Overall height	26 "
Overall width	30 "
Material	Stainless steel
Material code	1.4301 Chrome Nickel steel V2A
Waste hole position	Left side
Bowl finish	Satin finish
Number of bowls	1.00000
Overflow	No
Splash back	Yes
Number of tap holes	0.00000
Type of basin	Single compartment

PROJECT INFORMATION	
Item Location	
Project Number	
Quote Number	
Notes	
ENGINEER'S APPROVAL	

