

STAINLESS STEEL

# FIXTURES & ACCESSORIES

FOR THE EDUCATION SECTOR



*Make  
it  
Wonderful*

**FRANKE**







# CONTENTS

Benefits of stainless steel	04
Classroom sink solutions	05
Washroom solutions	09
Cafeteria solutions	15
Janitorial basin solutions	19
Hallway solutions	21





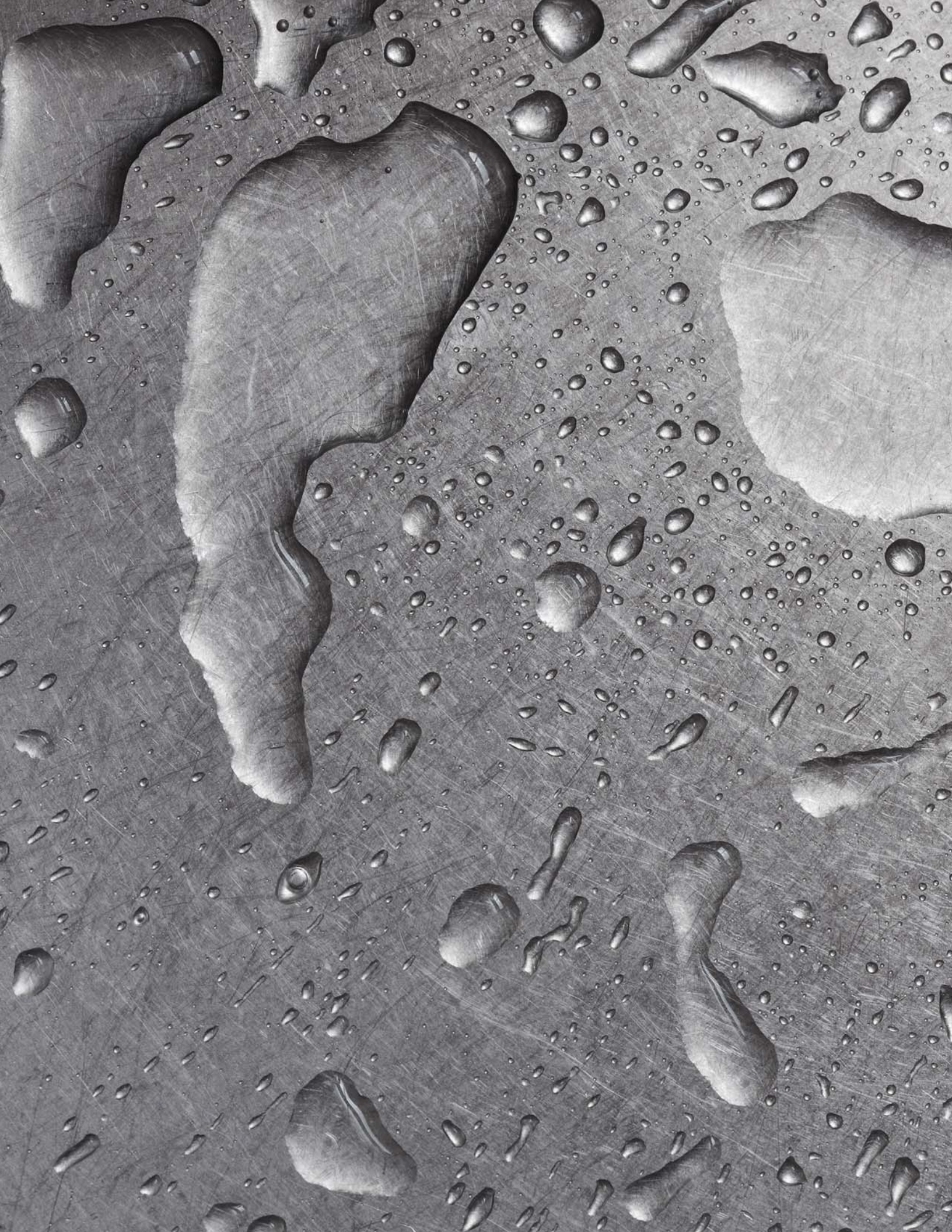





## THE BENEFITS OF STAINLESS STEEL

Educational institutions have a unique set of requirements for its fixtures. Why stainless steel is the perfect choice for this application group...

- Stainless steel is hygienic and easy to clean
- No cracks or crevices in which dirt and bacteria can hide
- Stainless steel is vandal resistant
- Wall mount basins do not require expensive cabinets, counter tops or concealed arm carriers

We offer a wide range of specialty sinks, drinking fountains, wash basins and accessories perfect for use in schools and educational institutions. So, whether it is the janitorial room or the cafeteria, you can outfit your institution in stainless steel fixtures for worry free maintenance.

# CLASSROOM SINK SOLUTIONS

We have a complete range of over 40 different classroom sinks to choose from. Classroom sinks feature **multiple ledge configurations** to allow for installation of both a faucet and drinking bubbler. This will limit the need for a student to leave the classroom for drink breaks.

Ledges back and left; back and right; back, left and right; opposing; right

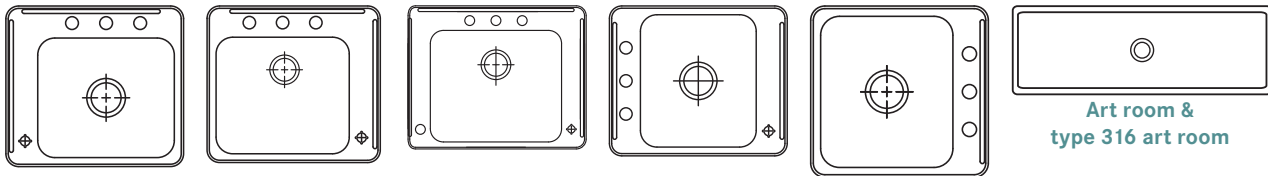

Alternatively, no ledge Art Room Sinks are a hand fabricated drop in utility sink for art rooms and school laboratories.

## Stainless Steel Type Requirements - 304 and 316

These are available in both type 304 stainless steel or type 316 with its enhanced corrosion resistant properties. Three standard widths are offered, 36" (914 mm), 48" (1219 mm), and 60" (1524 mm). More often, in laboratory settings, type 316 stainless steel is specified, while standard classroom sinks are typically type 304.

Generally, each school laboratory must contain a sink for handwashing. Exposure to hazardous materials and/or pathogenic organisms can occur by hand-to-mouth transmission. It is extremely important that hands are washed prior to leaving the laboratory. For this very reason, the sink should be located near the point of exit from the laboratory.<sup>1</sup>

As more corrosive materials are used in the laboratory, type 316 stainless is recommended for this application.

## How Corrosion Resistance Works?

TYPE 316 steel is an austenite chromium-nickel stainless steel that contains between two and three percent molybdenum. The molybdenum content increases corrosion resistance, improves resistance to pitting in chloride ion solutions and increases strength at high temperatures.

The addition of molybdenum up to a maximum of 3% distinguishes TYPE 316 from TYPE 304.

## What Does Type 316 Protect Against?

Molybdenum increases the corrosion resistance of this chromium-nickel alloy to withstand attack by many industrial chemicals and solvents, and, in particular, inhibits pitting caused by chlorides. As such, molybdenum is one of the single most useful alloying additives in the fight against corrosion.

By virtue of the molybdenum addition, Type 316 can withstand corrosive attack by

- sodium and calcium brines,
- hypochlorite solutions,
- phosphoric acid; and the
- sulfite liquors and
- sulfurous acids, such as those used in the paper pulp industry.

This alloy, therefore, is specified for industrial equipment that handles the corrosive process chemicals used to produce inks, rayons, photographic chemicals, paper, textiles, bleaches, and rubber.

## The Classroom Standard – Type 304

Within other classroom settings, the standard is TYPE 304 stainless steel which contains 18% chromium with 10% nickel. Constructed of a heavier steel than standard residential sinks, the heavier gauge is more durable, and bowls can be manufactured deeper to contain splashing. ■

1. "The Laboratory Biosafety Guidelines: 3rd Ed 2004". Retrieved 2015-10-16 [www.phac-aspc.gc.ca](http://www.phac-aspc.gc.ca)



H<sub>2</sub>O...

Water: It's essential to sustain life!

We can only survive without it for 3-5 days!

## WHAT IS DEHYDRATION?

Not only kids overheat on a hot summer day, but they can also become **dehydrated**, meaning their body does not have enough water. Water is very important since it makes up to 75% of the human body. Everyone loses water throughout the day from sweating and even breathing. When we sweat, we don't just lose water, but also important electrolytes such as salt and potassium. When children dehydrate they tend to heat up faster than adults. It is important to provide lots of opportunities for children to drink fluids when playing outside.



## Features and Benefits . . . CLASSROOM SINKS

### 1. Multiple Ledge Configurations

**Franke offers 5 different ledge configurations to choose from.**

The faucet ledges are available in multiple locations relative to the user, as if standing in front - at the counter's edge.

### 3. Soap Dispensers

Ledges are also commonly used for the installation of a soap dispenser.

### 2. Drinking Bubblers

**A bubbler ledge provides easy access to drinking water in class.**

With a bubbler installed at the sink, students may drink freely while in class. This reduces student disruptions since they do not need to leave the room for hydration purposes.



### 4. Premium 18 Gauge Stainless Steel

## The Classroom Range



ALBLS4605P-1  
ALBLS4606P-1  
LBLS4608P-1  
ALBLS6406P-1  
LBLS6408P-1  
ALBLS7005P-1  
ALBLS7006P-1  
LBLS7008P-1

ALBRS4605P-1  
ALBRS4606P-1  
LBRS4608P-1  
ALBRS7005P-1  
ALBRS7006P-1  
LBRS7008P-1

ALBLRS7005P-1  
ALBLRS7006P-1  
LBLS7008P-1  
ALBLRS7005P-1  
ALBLRS7006P-1  
LBLS7008P-1

ALHS4605P-1  
ALHS4606P-1  
LHS4608P-1  
ALHS6405P-1  
ALHS6406P-1  
LHS6408P-1  
ALHS7305P-1  
ALHS7306P-1  
LHS7308P-1  
ALHS8605P-1  
ALHS8606P-1  
LHS8608P-1

ALRS4605P-1  
ALRS4606P-1  
LRS4608P-1

ART36-1  
ART36-3C  
ART48-1  
ART48-3C  
ART60-1  
ART60-3C

ART36/316-1  
ART36/316-3C  
ART48/316-1  
ART48/316-3C  
ART60/316-1  
ART60/316-3C



# Faucet Hole Drilling Options

## CLASSROOM - LBSL SERIES

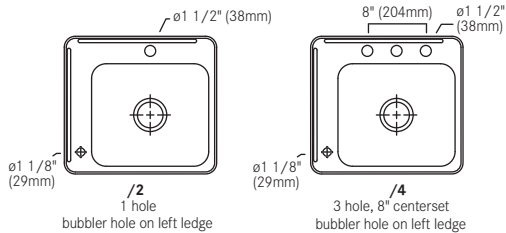

### BUBBLER HOLE DETAIL

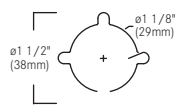

## CLASSROOM - LBRS SERIES

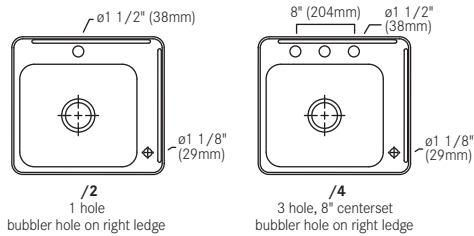

### BUBBLER HOLE DETAIL

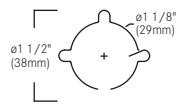

## CLASSROOM - LHS SERIES

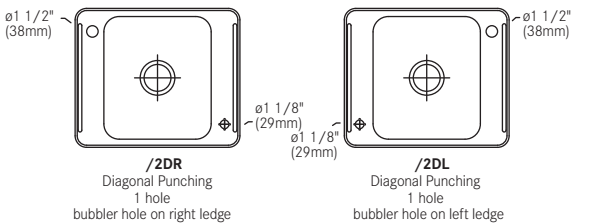
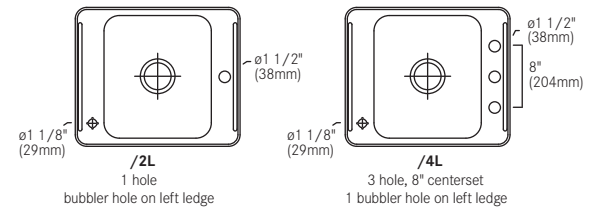
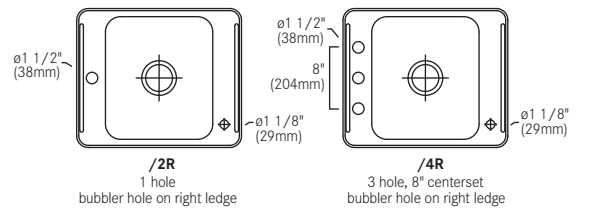

### BUBBLER HOLE DETAIL

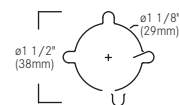

## CLASSROOM - LRS SERIES

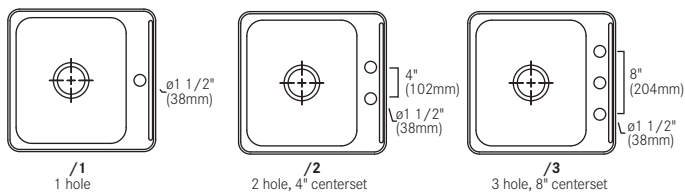

### BUBBLER HOLE DETAIL

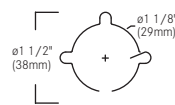

## CLASSROOM - LBLR SERIES

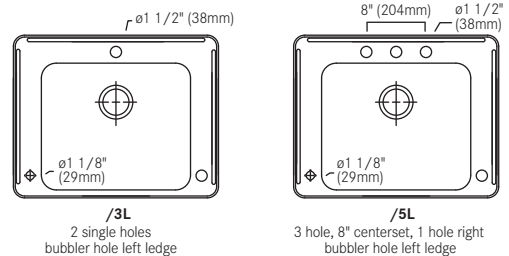
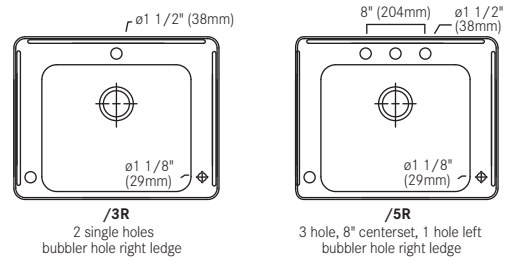

### BUBBLER HOLE DETAIL

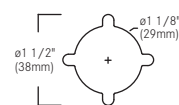

USA Only:



LBLDC1737P-1  
LBLDC1943P-1  
LBRDC1737P-1  
LBRDC1943P-1







## WASHROOM SOLUTIONS

Whether it's sinks or wall mount accessories you require, think of Franke. Our washroom solutions include paper towel or toilet tissue dispensers, soap dispensers and waste bins.

New for 2016 is an entirely new range called, EXOS. Stainless steel dispensers feature an interchangeable front panel of either black or white safety glass, if something other than a stainless look is desired.

We also carry the RODAN range with a full compliment of products.

Franke's commercial range boasts a large offering of counter mount, undermount, semi-recessed or wall mount stainless steel vanities and wash basins. To compliment the EXOS range, look to the new white mineral composite MIRANIT® sinks.

Drop-in and undermount vanities are offered both with and without overflow. As with our standard drop-in sinks, these vanity basins come complete with rim seal and are fully undercoated. Additional vanities include the newly introduced rectangular and U-shaped undermount basins (featured in photo far left).

Lastly, our wall hung WHB5222-7 provides two wash stations with the simplicity of only a single drain. The geometric styling is sure to please.









## Features and Benefits . . . RODAN ACCESSORIES

### 1. Sanitation Made Easy With Hygienic Stainless Steel

**Sanitary fixtures that inhibit vandalism and are easy to clean help building operators to keep service and maintenance costs to a minimum.**

Stainless steel is not only resistant to moisture and most acids, it also stands out due to its hardness, durability, high tolerance of heat and cold, and hygienic characteristics. Dirt and oil can easily be washed from the smooth, pore-free surface. Scratches and gouges on faceplates lose their sharp edges quickly and blend in to the surface.

### 3. Durable Stainless Steel

**The use of stainless steel as the material of first choice for products in public and semi-public washrooms has become today's standard for good reasons.**

This material is robust and, easy to maintain, and therefore is very durable which makes the products economical over the life time of the building.



### 2. Contemporary Design With Two Types of Mounting

**With over 100 years of experience in stainless steel, Franke delivers coordinated solutions for commercial sanitary facilities.**

These accessories provide the possibility of economical and aesthetic

design for customized washrooms. Note the angular side profiles which lends itself to the contemporary decor of heavily frequented washrooms. Rodan offers both recessed or surface mounting in several products. washrooms. Rodan offers both recessed or surface mounting in several products.

## The Rodan Range - 17 choices



#### Soap Dispensers

RODX617  
RODX618  
RODX618E  
RODX619  
RODX619E  
RODX625



#### Toilet Paper Dispensers

RODX672  
RODX672E



#### Waste Bins

RODX602  
RODX602E  
RODX605  
RODX605E  
RODX611



#### Paper Towel & Tissue Dispensers

RODX600  
RODX600E  
RODX600ME  
RODX630

Vitreous china washroom



Stainless steel washroom



## WHY RISK THIS KIND OF VANDALISM?



### Stainless steel - the perfect vandal resistant choice

To further exploit the possibilities of stainless we offer wall hung toilets as well as a flushing urinal. No floor mounted toilets which make it difficult to clean around.

The toilet is a low consumption blowout jet which uses 1.6gpf / 6 lpf. Top and rear spud connections available.

The flushing urinal consumes only 0.5gpf / 1.9 lpf.

## OPTIONS



**Vandal Resistant**  
HDWC2414-RM



**Top Spud**  
HDU1314-RM



**Low Flush**  
CMPX538



## Features and Benefits . . . SINKS & OTHER ACCESSORIES

### 1. Stainless steel – the smart alternative to vitreous china sinks

**Not only are they hygienic but they are vandal resistant and easy to clean.**

### 2. Cost effective

**No countertop. No cabinet. No arm carriers.**

The WHB series of stainless sinks (featured in photo left) provide a reduction in labour costs by negating the need for expensive cabinets, countertops and arm carriers. Furthermore, the dual station, WHB5222-7, services 2 people but only requires a single plumbing installation.

### 3. Complimentary accessories

**Mirrors, grab bars, toilet paper dispensers...whatever you need, we have it.**

This range features dispensers, bins and wheelchair aids, for a cohesive, easy-to-maintain public washroom.

## Recommended Sinks, Basins, and Other Accessories

Available in Canada only 🇨🇦



**Oval**  
V1114/5D  
🇨🇦



**Faucet Ledge**  
V1821/5/1  
V1821/5/3  
🇨🇦



**Round**  
V17/5  
🇨🇦



**Undermount**  
OV1317U/5  
🇨🇦



**U-Shape Undermount**  
OWB1420U/5  
🇨🇦



**Hand Fab Styling**  
WB1119/U-5  
🇨🇦



**Wall Mount  
Vitreous Alternative**  
WHB2221-7



**Wall Mount  
Dual Station**  
WHB5222-7



**Fixed Position Tilt Mirror**  
F3200FT



**1 1/4" Ø Peened Stainless Grab Bar**  
QC-1W-18P



**Handicap Washroom Back Rest**  
CM-16104  
CM-16104-WM







## CAFETERIA SOLUTIONS

Multiple compartments and non-corrodible metal are the recommended sinks for food safe practices in Canada. As shown in the FS (Food Services) Code following, multiple bowls are preferred for the three stages of sanitation. The FS Code also recommends drainboards where possible to allow for air drying - where time permits.

Not only is a non-corrodible material recommended but it must contain a minimum of 16% chromium. Franke meets all these requirements and more!

Our RESTAURANT SERIES SCULLERY SINKS are fabricated of robust 14 gauge 18/10 stainless steel. This means it contains 18% chromium and 10% nickel. These sculleries are constructed with hygiene and food safety in mind. The radius coved bowl corners are easy to clean and there are no cracks or seams in which bacteria can collect and grow.





### Manual Dishwashing, Food Services Code

"Where manual dishwashing procedures are used for cleaning and sanitizing cooking utensils, the manual dishwashing equipment should include:

- i) at least a **double sink** of **non-corrodible metal** of sufficient size to permit complete immersion of the utensils to be sanitized;
- ii) **draining boards** (if they are to be provided) of non-corrodible and non-absorbent material;..."<sup>4</sup>

### Maintenance and Sanitation, Food Services Code

"When relying on the manual method for washing and sanitizing dishware and serving/dining utensils, the operator should use a **two or three compartment sink** and the following procedure. Dishes should be:

- i) thoroughly scraped clean of gross foreign materials and food scraps;
- ii) washed in the **first compartment** sink in detergent solution capable of removing grease and food particles and that is maintained at a temperature of not less than 45° C (113° F);
- iii) rinsed in the **second compartment** sink in clean potable water maintained at a temperature of not less than 45°C (113°F); and

- iv) sanitized in the **third compartment** sink by immersion, in one of the following methods:
  - for at least 2 minutes in water at a temperature of at least 77°C (171°F);
  - for at least 2 minutes in a chlorine solution of 100 - 200 mg/L available chlorine at a temperature of not less than 45°C (113°F);
  - for at least 2 minutes in a solution containing a quaternary ammonium compound having a strength of not higher than 200 mg/L consistent with efficacy at a temperature of not less than 45°C (113°F)
  - for at least 2 minutes in a solution containing not higher than 25 mg/L iodine at a temperature of not less than 45°C (113°F); or
  - in accordance with any other method that has been scientifically proven to produce results equivalent to those achieved by use of any of the methods in this subclause
- (iv) NOTE: The solutions used for the methods outlined in (iv) should be completely changed often enough to prevent utensils from becoming soiled and to maintain the bactericidal effect of the solution.
- v) **air-dried**, if possible..."<sup>5</sup>

4-5. "4.2.8 Food Retail and Food Services Code: Amended Sept, 2004". Retrieved 2015-06-16 [www.foodsafe.ca/resources](http://www.foodsafe.ca/resources)

## Recommended Scullery Sinks

---

### RESTAURANT SERIES



#### Single Restaurant Sculleries

RSL2418-1  
RSL2418L-1  
RSL2418LR-1  
RSL2418R-1  
RSL2424-1  
RSL2424L-1  
RSL2424LR-1  
RSL2424R-1



#### Double Restaurant Sculleries

RDL2436-1  
RDL2436L-1  
RDL2436LR-1  
RDL2436R-1  
RDL2448-1  
RDL2448L-1  
RDL2448LR-1  
RDL2448R-1



#### Triple Restaurant Sculleries

RTL2454-1  
RTL2454L-1  
RTL2454LR-1  
RTL2454R-1  
RTL2472-1  
RTL2472L-1  
RTL2472LR-1  
RTL2472R-1

## Drainboard Options for Service Series, Restaurant Series, World Class Series

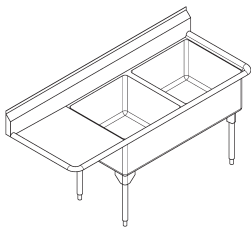

Drainboard Left

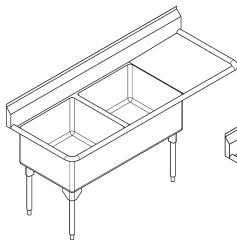

Drainboard Right

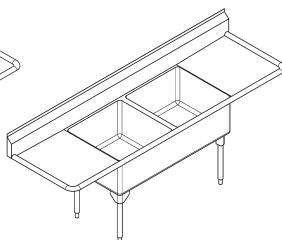

Drainboards Left & Right

For a more economical alternative to the all radius coved corners of the Restaurant Series, see Classic Series – Janitorial Section. Classics are well suited for applications such as janitorial.

Although the preceeding information within this section is pertinent to British Columbia in particular, we feel the recommendations are sound advice throughout North America.







# JANITORIAL SINK SOLUTIONS

## Recommended Janitorial Sinks/Basins

**Floor Mount Mop Sink**



FSS222210/316-1  
FSS2210/316-1  
FSS02210/316-1  
FSSL223410/316-1  
FSSR223410/316-1  
FSSOL223410/316-1  
FSSOR223410/316-1

**Wall Mount Service Sink**



WSS6713

**Classic Series Scullery Sinks**



SL2424-1  
SL2424-5  
SL2448-1  
SL2448-5

DL2448-1  
DL2448-5

TL2454-1  
TL2454-5  
TL2472-1  
TL2472-5

**DRAINBOARD FOR CLASSICS**



CL-DB

## Features and Benefits . . . MOP SINKS

### 1. Versatile Installation

**Can be installed in either LEFT or RIGHT corners.**

This makes the mop sink extremely versatile. Should the need arise to renovate, this sink will install against any corner.

### 2. Integral Walls

**Both a backsplash and side splash are built right into the design.**

No need to add tiling or additional materials to catch splashing water. This seamless design feature makes cleaning a breeze.

### 3. Easy Dumping Of Dirty Water

**Power driven floor cleaning equipment can be easily dumped into the sink.**

The lower front panel allows for easy access into the basin without lifting over a high ledge.

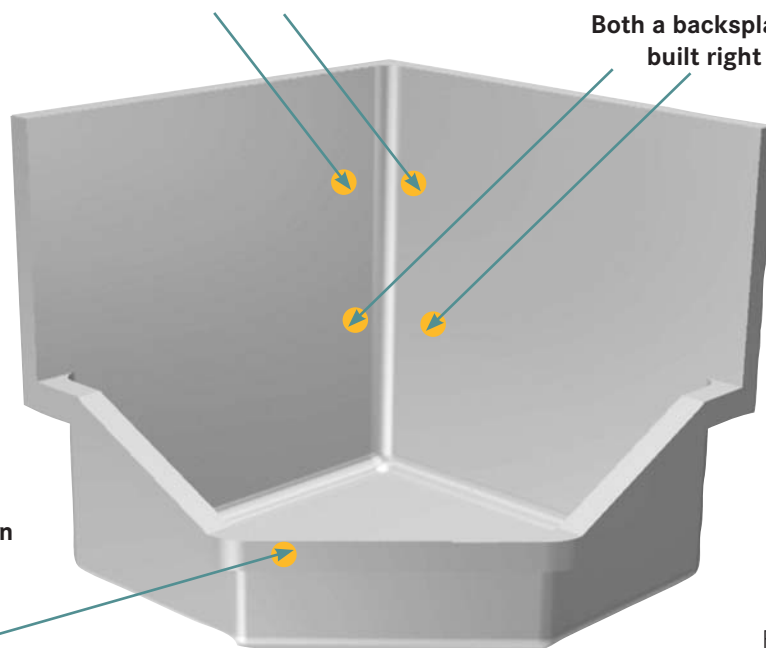

FSS02210/316-1 shown

### 4. Durable

**Stainless steel construction.**

This alternative to solid surface mop sinks means there is no chance of chipping or cracking.

### 5. Quick to Install

**Two wall carriers support the mop sink.**

The diagrams below show the location of wall carriers and the floor drain. Quick and easy to install. The sink includes a 2" IPS grid shower drain.

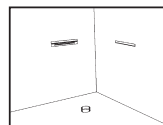

Prepare wall with supplied carriers



View from front indicating location of carriers and drain

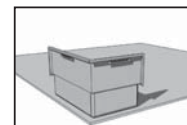

View from behind showing mop sink installed

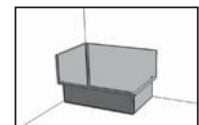

View from front showing mop sink installed

## HALLWAY SOLUTIONS

Delivering safe, fresh water for everyone at any time.  
Available as chilled or non-chilled.

Most models are wheelchair compliant when installed  
as per installation instructions.

Cabinet finishes include hygienic stainless steel or a  
power coated sandstone colour.





## Features and Benefits . . . DRINKING FOUNTAINS

### 1. The Best of Both Water Options

#### REFRESHING FOUNTAIN WATER + BOTTLE FILLER

The bottle filler alcove and activation button contain Freshield®, which utilizes a silver based antimicrobial compound. This is ideal for work-place settings, schools, university locations, and any public building.

KEPACSL-SBF-SND Shown

### 3. Sandstone or Stainless Steel Cabinet Options

Although not every model is available in a choice of cabinet finishes, either one is extremely durable.

**Stainless Steel Bowls** are standard on all models but cabinets are available in Stainless Steel or on many models in a Sandstone finish.

**Sandstone Powder Coating** on galvanized steel gives our product significantly greater durability, which translates into lower life cycle cost. The coating, a mixture of finely ground particles of pigment and resin, is sprayed and baked on for complete coverage and strong adhesion.

The finish resists cracking, corrosion, scratches, fading, impact and abrasion. And on top of all that, it's beautiful!

### 2. Electronic Option

The Bottle Filler may be ordered in the electronic version.

The **Bottles Saved** indicator on the electronic bottle filler (**KEPWEBF**) changes the count each time a minimum of 250 ml of water is dispensed.

A **Filter Status** indicator on the electronic bottle filler changes colour when it is time to replace the filter cartridge.

### 4. Feature Choices

- Electronic fountain activation models
- Vandal resistant models
- Energy and water conservation models
- Barrier free models
- Wall mount or floor models
- With or without chillers, either installed within wall cavity or remotely located
- Single or double for both child and adult mounting heights



## HOW DRINKING WATER IMPROVES LEARNING

The key to boosting the capacity to learn is to keep well hydrated throughout the day.

“When we are thirsty mental performance – including memory, attention and concentration – can decrease by about 10 per cent.

10%

“Pupils concentrate better because they are not distracted by the effects of dehydration such as thirst, tiredness and irritability can aid behaviour management by helping to settle pupils in the classroom. Children will achieve more when both their health and learning needs are met. Ensuring free access to water and promoting a regular water intake throughout the school day is a vital role for schools in promoting health and providing a healthy learning environment.”<sup>3</sup>

## DRINKING WATER GUIDE

6 – 8 GLASSES A DAY, OR

1.5 – 2 LITRES A DAY, AND AT LEAST:

3 – 4 GLASSES (.75 – 1) LITRE A DAY WHILE AT SCHOOL.

3. Findings from a study called, WATER IS COOL IN SCHOOL campaign conducted by Education and Resources for Improving Childhood Continence (ERIC), in conjunction with the Royal College of Paediatrics and Child Health, UK. 2011





## THE TRUTH ABOUT BOTTLED WATER

40% of bottle water is actually tap water. And many people can't even tell the difference in taste tests. Did you know that many plastic bottles and water coolers are made of Bisphenol A (BPA)?

Because BPA is an unstable compound .....[it] can move quickly into people..... Two studies have explored the effects of increased ingestion of food and drink packaged in materials containing endocrine-disrupting compounds. Both found rapid increases (within a few days to a week) in BPA levels in urine and/or blood samples taken from subjects who intentionally increased their intake of common foods and drinks packaged in BPA-containing products (Carwile, 2009; Smith, 2009).<sup>4</sup> Although the Canadian government has not regulated against BPA, why chance it?.

It takes 3 times as much water to produce bottles as it does to fill them. Oil is used in bottle production and shipping. Most bottles never get recycled. Plastic takes over 300 years to degrade in nature. Plastic was invented 140 years ago and it is all still here, piling up in our landfills, oceans and communities.<sup>5</sup> Birds and fish alike have been found dead of plastic ingestion; dissection has shown their stomachs filled with plastics of all sorts.

4. Bisphenol A (BPA). Retrieved 2015-06-26 [www.breastcancerfund.org](http://www.breastcancerfund.org)

5. Tap vs Bottled Water. Retrieved 2015-06-26 [www.slideshare.net](http://www.slideshare.net)







Available in Canada Only

## Recommended Drinking Fountains/Bottle Fillers



### COMBINATION FOUNTAINS



**Electronic: Chilled/Unchilled**  
KEPACSL-EBF-SND(STN)  
KEP8ACSL-EBF-SND(STN)



**Manual: Chilled/Unchilled**  
KEPACSL-SBF-SND(STN)  
KEP8ACSL-SBF-SND(STN)



**Chilled/Unchilled**  
KEPAC-SBF-SND(STN)  
KEP8AC-SBF-SND(STN)



**Vandal Resistant**  
KEPVAC-SBF(EBF)-STN  
KEPV8AC-SBF(EBF)-STN



### BOTTLE FILLERS



**Stand Alone**  
KEPWMSBF-STN



**Stand Alone  
(electronic activation)**  
KEPWMEBF-STN



KEMWSMEBF-STN

### CLASSIC, FREE-STANDING



KEP3CP-SND  
KEP5CP-SND  
KEP10CP-SND

### UNIVERSAL FOUNTAINS



**Vandal Resistant**  
KEPV8AC-STN  
KEP8AC-STN



**Chilled/Unchilled**  
KEP8AC-STN  
KEPAC-STN

### MODULAR FOUNTAINS



**Vandal Resistant**  
KEM110PM-STN

### UNIVERSAL SPLIT LEVEL FOUNTAINS



**Vandal Resistant**  
KEPV8ACSL-STN



**Chilled/Unchilled**  
KEP8ACSL-SND(STN)  
KEPACSL-SND

More models available online at  
[www.franke-commercial.com](http://www.franke-commercial.com)



Franke Kindred Canada Ltd.  
Commercial Systems  
1000 Franke Kindred Road  
Midland, ON L4R 4K9  
[www.franke-commercial.com](http://www.franke-commercial.com)

Dimensions, Designs and  
Fabrication are subject  
to change

Printed in Canada.

Recommended Fixtures  
For The Education Sector

Revision 01

**61895**  
06.2016

CANADA:  
Tel 855-446-5663  
Fax 866-227-3050  
[ws-info.ca@franke.com](mailto:ws-info.ca@franke.com)

USA:  
Tel 855 526-0503  
Fax 866-440-2250  
[commercial-info.us@franke.com](mailto:commercial-info.us@franke.com)

