

TL2472-5 Triple, 16 gauge

MODEL RANGE: COMMERCIAL SINKS | TL2472-5

Utility sinks | Multi purpose sinks

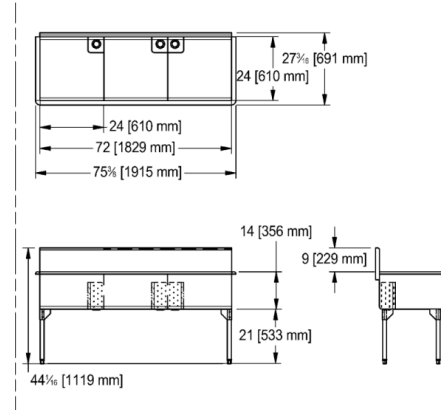

Triple compartment scullery sink. 16 gauge (1.5 mm), type 304 (CNS 18/10) stainless steel. Polished to a #4 satin finish. Sink compartments sloped to drain with radius coved corners on front and back only. Rolled rim. Stainless steel tubular legs with adjustable feet. Includes waste fittings. Certified to ASME A112.19.3-2008 / CSA B45.4-08
Right rear/right rear/left rear waste location. Includes 1 1/2" (38 mm) duplex waste assembly with rubber stopper, 1 1/2" (DN38) brass tailpiece, and standpipe with guard.

Model Options:

TL2472-5/2, 2 faucet holes, 1 1/4" diameter, 8" centreset

TL2472-5, Custom, non-returnable

27 3/16 x 75 3/8" Overall. 24 x 24 x 14" Bowl. (FB x LR x D).
691 x 1915 mm Overall. 610 x 610 x 356 mm Bowl. (FB x LR x D).

Technical data

Bowl height	14 inch
Bowl depth	24 "
Bowl width	24 "
Overall depth	27 3/16 "
Overall height	44 "
Overall width	75 3/8 "
Material	Stainless steel
Material code	1.4301 Chrome Nickel steel V2A
Tailor made	No
Tap ledge	No
Waste hole position	Right back corner
Bowl finish	Satin finish
Overflow	No
Splash back	Yes
Type of waste kit	DUPLEX-WASTE
Bowl construction	Radius coved front and back only
Drainer or storage	No

PROJECT INFORMATION

Item Location
Project Number
Quote Number
Notes

ENGINEER'S APPROVAL

TL2472-5 Triple, 16 gauge

MODEL RANGE: COMMERCIAL SINKS | TL2472-5

Utility sinks | Multi purpose sinks

Accessory Optional



CL-DB Drainboard for Classic Series

2000102973

CL-DB

Spare Parts



310-1 10" Stand pipe

2000103039

310-1
