

WHB1617-3 Wall Hung, 18 gauge

MODEL RANGE: TUBS-BASINS | WHB1617-3

Hand wash basins | Wash basins

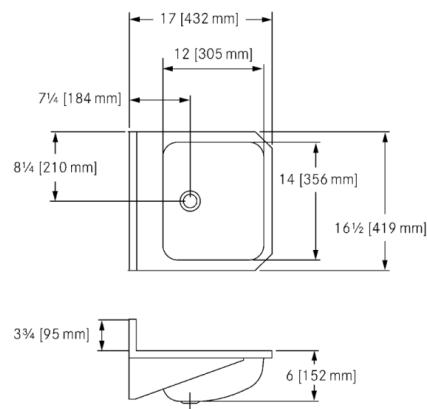

Wall hung basin. Centre back waste location. 18 gauge (1.2 mm), type 304 (CNS 18/10) stainless steel. Exposed surfaces are #4 satin finished. Radius coved bowl corners. One piece wall hanger. Waste assembly included. Certified to ASME A112.19.3-2008 / CSA B45.4-08.

Separate sink carrier is not required. 1 1/2" (38 mm) duplex waste assembly with rubber stopper and 1 1/2" (DN40) brass tailpiece included. Optional shroud model, WT-RS.

Model Options:

WHB1617-3/1, 1 faucet hole, 1 1/2" diameter

WHB1617-3/3, 3 faucet holes, 1 1/2" diameter, 4" centreset

WHB1617-3, Custom (non-returnable)

17 x 16 1/2" Overall. 12 x 14 x 6" Bowl. (FB x LR x D).

432 x 419 mm Overall. 305 x 356 x 152 mm Bowl. (FB x LR x D).

Technical data

Bowl height	6 inch
Bowl depth	12 "
Bowl width	14 "
Overall depth	17 "
Overall height	9 3/4 "
Overall width	16 1/2 "
Material	Stainless steel
Material code	1.4301 Chrome Nickel steel V2A
Tailor made	No
Waste hole position	Center back
Bowl finish	Satin finish
Number of bowls	1.00000
Overflow	No
Splash back	Yes
Number of tap holes	0.00000
Type of waste kit	DUPLEX-WASTE

PROJECT INFORMATION

Item Location	
Project Number	
Quote Number	
Notes	

ENGINEER'S APPROVAL

WHB1617-3 Wall Hung, 18 gauge

MODEL RANGE: TUBS-BASINS | WHB1617-3

Hand wash basins | Wash basins

Accessory Optional

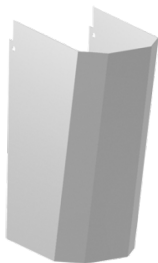

WT-RS Shroud, removable, 18 gauge

2000103036

WT-RS
