

RC6/316 Cup sink, round, 20 gauge T316

MODEL RANGE: COMMERCIAL SINKS | RC6-316

Type 316 stainless sinks | Cup sinks

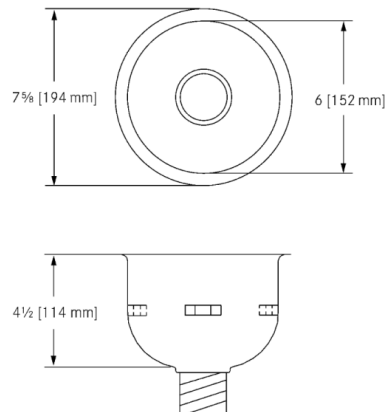

Single bowl commercial laboratory sink. 20 gauge (0.9 mm), type 316 (EN1.4401 17/12/2) stainless steel. Exposed surfaces are sand-blast finished. Positive hold down clamping. 1 1/2" (38 mm) type 316 (EN1.4401 17/12/2) stainless steel duplex waste assembly is integral (tailpiece optional*). Certified to ASME A112.19.3-2008 / CSA B45.4-08.

Centre waste location.

These sinks do not include tailpiece. A type 316 tailpiece is available by ordering 315-9/316.

7 5/8 x 7 5/8" Overall. 6 x 6 x 4 1/2" Bowl. (FB x LR x D).

194 x 194 mm Overall. 152 x 152 x 114 mm Bowl. (FB x LR x D).

Technical data

Bowl depth	4 1/2 inch
Bowl width	6 "
Bowl width	6 "
Overall depth	7 5/8 "
Overall width	7 5/8 "
Material	Stainless steel
Material code	1.4404
Tailor made	No
Waste hole position	Center
Bowl finish	Satin finish
Number of bowls	1.00000
Overflow	No
Number of tap holes	0.00000
Type of waste kit	Threaded tailpiece
Type of basin	Single compartment

PROJECT INFORMATION

Item Location
Project Number
Quote Number
Notes

ENGINEER'S APPROVAL