

WB1420U/5 Undermount, U-shaped

MODEL RANGE: COMMERCIAL SINKS | WB1420U-5

Vanity basin | Undermount

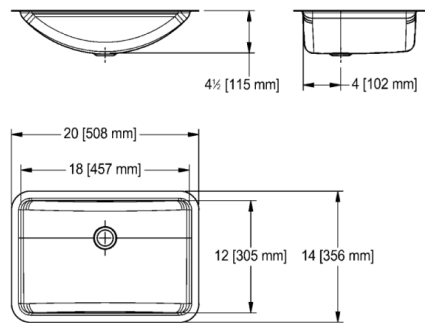

Single compartment undermount vanity basin. 18 gauge (1.2 mm), type 304 (CNS 18/10) stainless steel. Exposed surfaces are #4 satin finished. Undercoated to reduce condensation and resonance. Includes cutout template. Certified to ASME A112.19.3-2008 / CSA B45.4-08.

Centre back waste location, accepts 1 1/4" (32 mm) waste assembly (not included).

14 x 20" Overall. 12 x 18 x 4 1/2" Bowl. (FB x LR x D).

356 x 508 mm Overall. 305 x 457 x 114 mm Bowl. (FB x LR x D).

Technical data	
Bowl height	4 1/2 inch
Bowl depth	12 "
Bowl width	18 "
Material thickness	1/16 mm
Overall depth	14 "
Overall width	20 "
Material	Stainless steel
Tap ledge	No
Waste hole position	Center back
Bowl finish	Satin finish
Number of bowls	1.00000
Overflow	No
Surface finish	Satin finished
Number of tap holes	0.00000
Waste kit included	No
Waste size	DN 32
Type of basin	Vanity basin

PROJECT INFORMATION	
Item Location	
Project Number	
Quote Number	
Notes	

ENGINEER'S APPROVAL

