

Installation Guide

Easy Installation

D.I.Y

NOTE:

PLEASE PLACE ALL THE PRODUCTS AT ROOM TEMPERATURE AND DO NOT STORAGE THE BIDETS AND ITS ASSESSORIES IN THE FREEZING TEMPERATURE ENVIRONMENTS UNDER 0 DEGREE CELCIUS!

1. NAMES AND FUNCTIONS OF PARTS

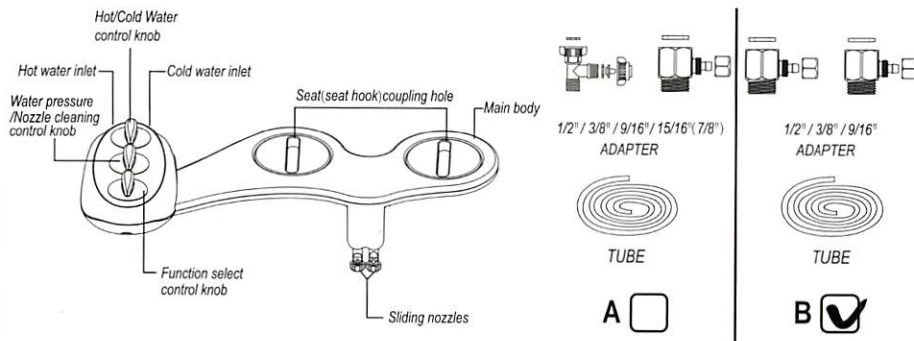

Installation Tools May Needed



2. INSTALLATION

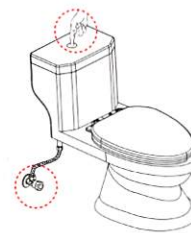

1. Turn off the water supply, flush the toilet to drain the tank

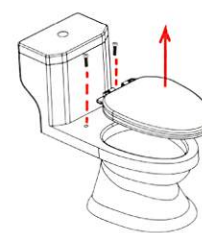

2. Remove toilet seat



3. Install bidet



4. Install toilet seat

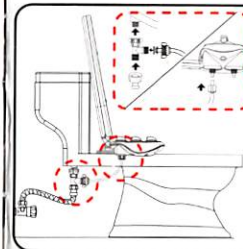

A

5. Connect cold water supply to bidet

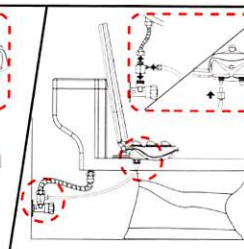

B

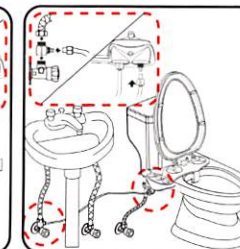

A

6. Connect hot water supply to bidet

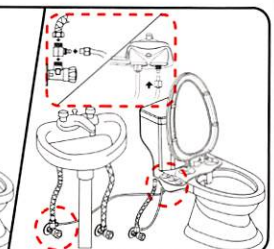

B

3. FINAL ASSEMBLED FIGURE

IMPORTANT:
Carefully check all connections for any leaks.

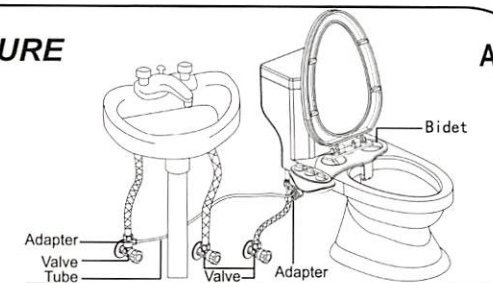

A

Troubleshooting

If the sliding nozzle jammed for some reason, simply try to move sliding nozzle up and down for a few times manually.

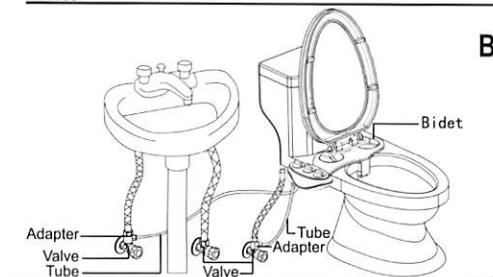

B