

ONEX[®]

STAINLESS STEEL SINKS

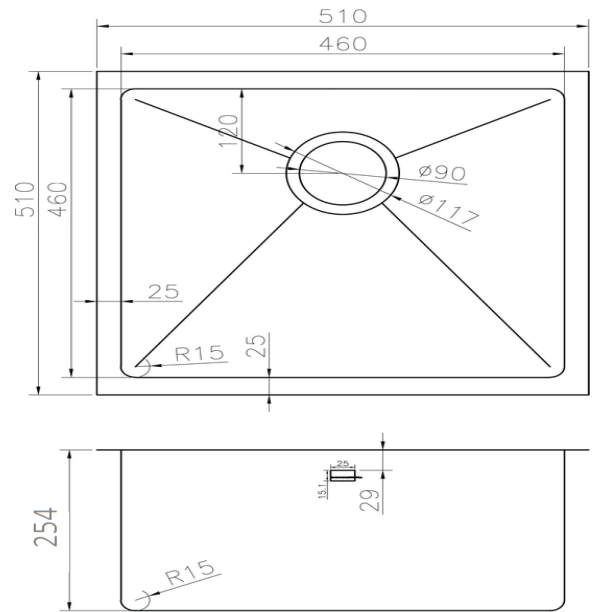

MODEL OUS2020-SQR

OVERALL SIZE	510 mm X 510 mm	<ul style="list-style-type: none"> • 304 brushed finish stainless steel 18 gauge • Stainless steel strainer, clips and template included • Sound deadening pads • Drain located towards rear to provide more space under the sink • Product certified ASME A112.19.3, CSA B45.0, and CSA B45.4
BOWL SIZE	460 mm X 460 mm	
DEPTH	254 mm / 10"	