

TYPE 600 FORGED BRASS, BALL VALVES

Fig: 5049A

Sizes: 3/8-3inch(10-80mm)

FULL BORE, SOLDER ENDS.

Standards

. End to End: MANUFACTURERS STANDARD

. End Connection: ASME B16.18

. Wall Thickness: MANUFACTURERS STANDARD

Test Standard

. MANUFACTURERS STANDARD

Dimensions

SIZE(inch/mm)		L	L1	H	D1	Kg
3/8	10	46.0	0.0	37.0	70.0	0.00
1/2	15	54.0	0.0	40.0	80.0	0.00
3/4	20	73.0	0.0	44.0	80.0	0.00
1	25	88.0	0.0	50.0	110.0	0.00
1 1/4	32	100.0	0.0	55.0	110.0	0.00
1 1/2	40	115.0	0.0	65.0	150.0	0.00
2	50	140.0	0.0	72.0	150.0	0.00
2 1/2	65	164.0	0.0	101.0	200.0	0.00
3	80	187.0	0.0	113.0	300.0	0.00

Material List

NAME OF PART	MATERIAL	SPECIFICATION
BODY	FORGED BRASS	B283 NO. C37700
BODY CAP	FORGED BRASS	B283 NO. C37700
STEM	BRASS ROD (5)	B16
BALL	FORGED BRASS (3)	B283 NO. C37700

Specifications

TYPE 600 FORGED BRASS, BALL VALVES, FULL BORE, SOLDER ENDS.

End to End : MANUFACTURERS STANDARD, End Connection : ASME

B16.18, Wall Thickness : MANUFACTURERS STANDARD, Test Standard :

MANUFACTURERS STANDARD, Sizes : 3/8-3inch(10-80mm), BODY MATERIAL

: FORGED BRASS, BODY CAP MATERIAL : FORGED BRASS, STEM MATERIAL : BRASS

ROD (5), BALL MATERIAL : FORGED BRASS (3), Fig : 5049A

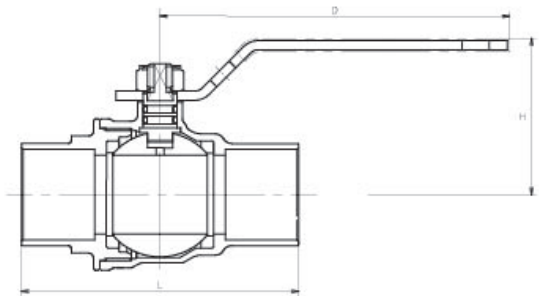

For more details, please refer to the drawing.

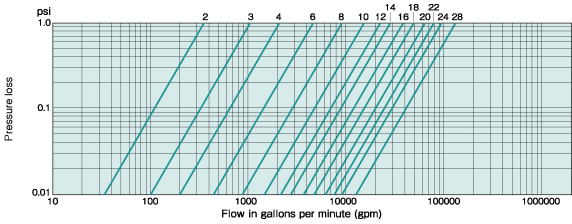

Pressure-temperature ratings and other performance data published in this catalog have been developed from our design calculation, in-house testing, field reports provided by our customers and/or published official standards or specifications. They are good only to cover typical applications as a general guideline to users of KITZ products introduced in this catalog. For any specific application, users are kindly requested to contact KITZ Corporation for technical advice, or to carry out their own study and evaluation for proving suitability of these products to such an application. Failure to follow this request could result in property damage and/or personal injury, for which we shall not be liable. Read instruction manual carefully before use.