

#### FEATURES:

- Brass construction
- Adjustable 1/2" or 3/4" Quarter-turn Ceramic Disk Cartridge
- 1/2" or 3/4" NPT connections
- Intended for use with the Rubinet 1/2" or 3/4" Thermostatic Mixer Valve
- Flow Rate 4KR100 / 4KR000 (1/2") : 7.0 gpm @ 50 psi  
4KR300 / 4ER000 (3/4") : 11.0 gpm @ 50 psi

#### 4KR100 / 4KR000

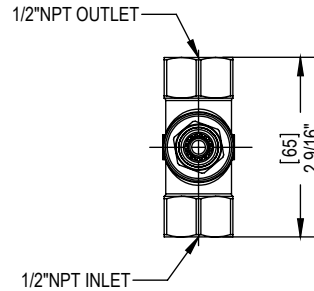
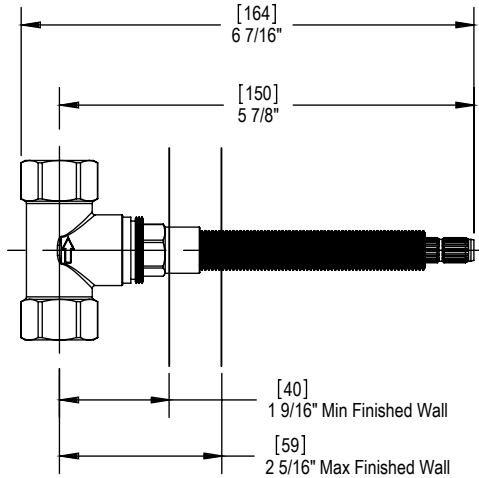

#### 4KR300 / 4ER000

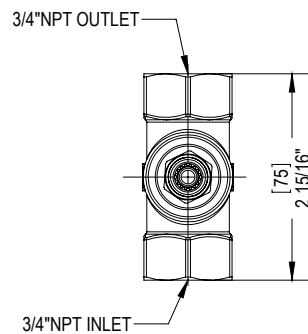
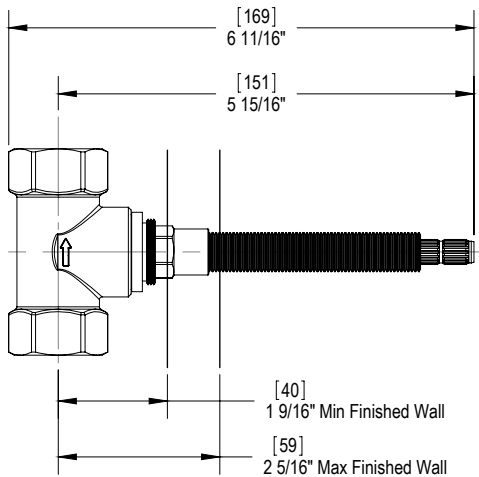

#### CONTACT US:

If you need assistance with installation, replacement parts or have any questions regarding your Rubinet product, please call a Customer Service representative at: 905-851-6781 toll free 1-800-461-5901 or visit [www.rubinet.com](http://www.rubinet.com)

170704

THE **Rubinet** FAUCET COMPANY

#### ASSEMBLY INSTRUCTION

4KR100 (4KR000) / 4KR300 (4ER000)

VOLUME CONTROL VALVE ROUGH-IN



4KR100 (1/2")  
4KR000 (1/2")

4KR300 (3/4")  
4ER000 (3/4")

#### REMOVAL OF FIXTURE:

Always turn the water supply off before removing the existing fixture or disassembling a valve. Open all fixture handles to relieve water pressure and to ensure that the water has been successfully turned off.

1

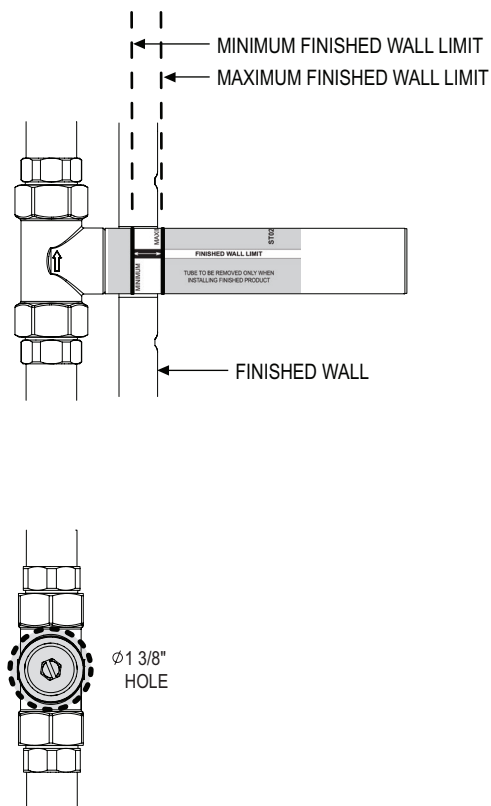

PROTECTIVE COVER **MUST NOT BE REMOVED** WHEN PLASTERING AND/OR TILING.

2

