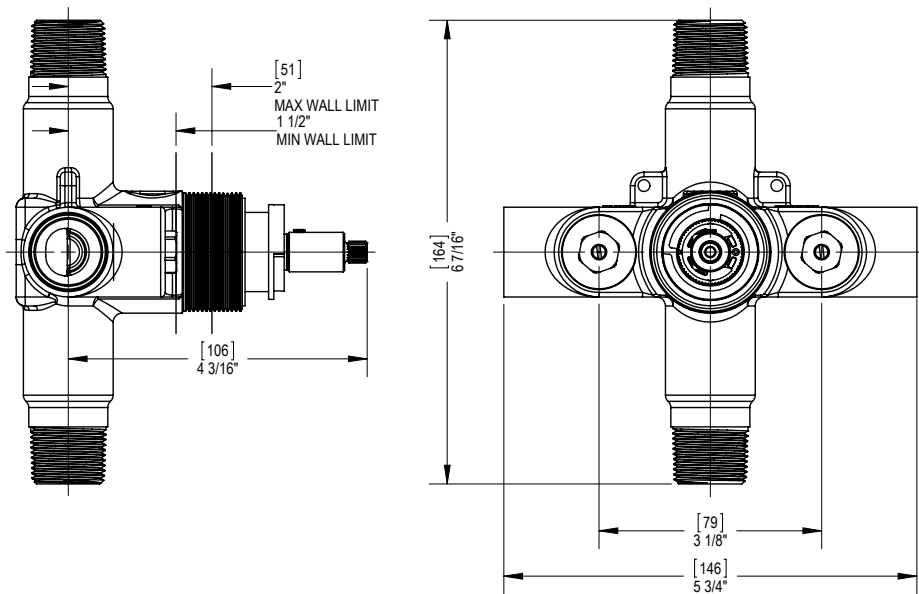

FEATURES:

- Brass construction
- Mixer control
- Factory preset at 38°C (100.4°F)
- Temperature range from 15°C (59°F) to 60°C (140°F)
- Safety stop with override function
- Flow Rate 4MR000 / 4MR100 (1/2") : 8.0 gpm @ 50 psi
4DR000 / 4MR300 (3/4") : 10.0 gpm @ 50 psi

APPROVAL:

- ASME A112.18.1 / CSA B125.1
- ASSE 1016 / ASME A112.1016 / CSA B125.16

**CONTACT US:**

If you need assistance with installation, replacement parts or have any questions regarding your Rubinet product, please call a Customer Service representative at: 905-851-6781 toll free 1-800-461-5901 or visit www.rubinet.com

170704**THE Rubinet** FAUCET COMPANY**ASSEMBLY INSTRUCTION****4MR100(4MR000) / 4MR300(4DR000)****TEMPERATURE CONTROL VALVE WITH BUILT-IN STOPS ROUGH-IN****4MR000 (1/2")
4MR100 (1/2")****4DR000 (3/4")
4MR300 (3/4")****REMOVAL OF FIXTURE:**

Always turn the water supply off before removing the existing fixture or disassembling a valve. Open all fixture handles to relieve water pressure and to ensure that the water has been successfully turned off.

1

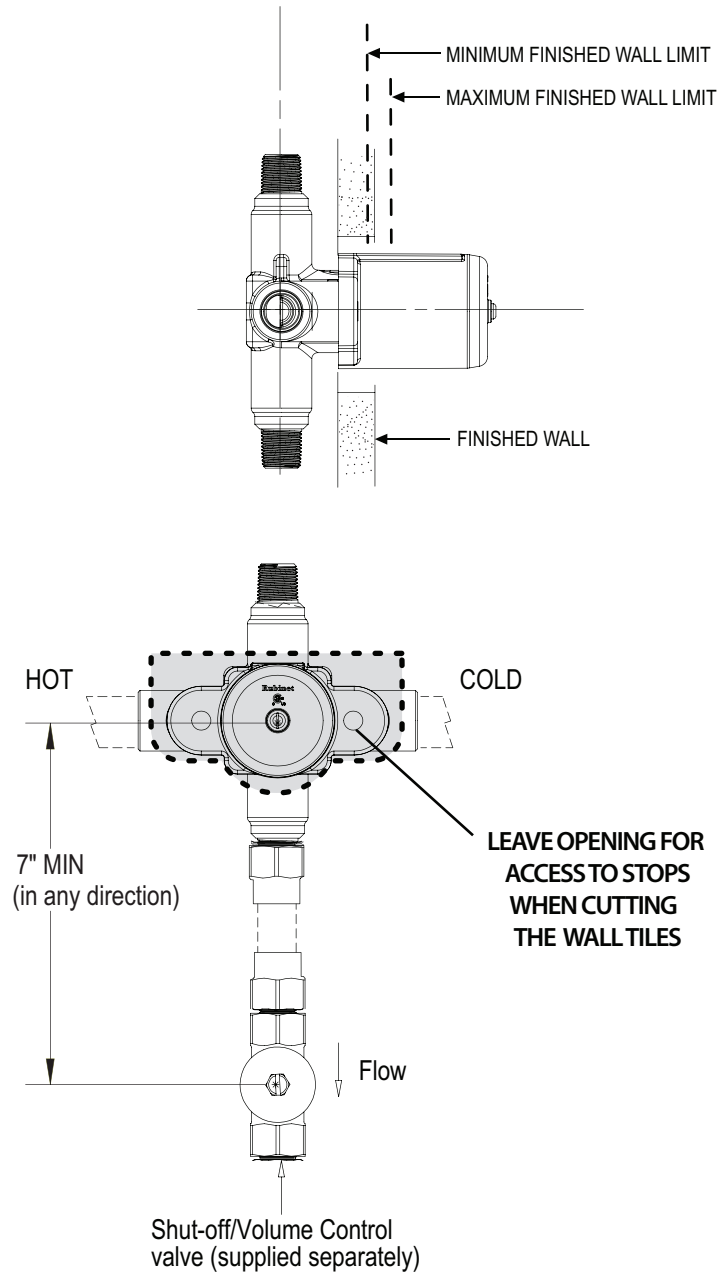

PROTECTIVE COVER **MUST NOT BE REMOVED** WHEN PLASTERING AND/OR TILING.

2

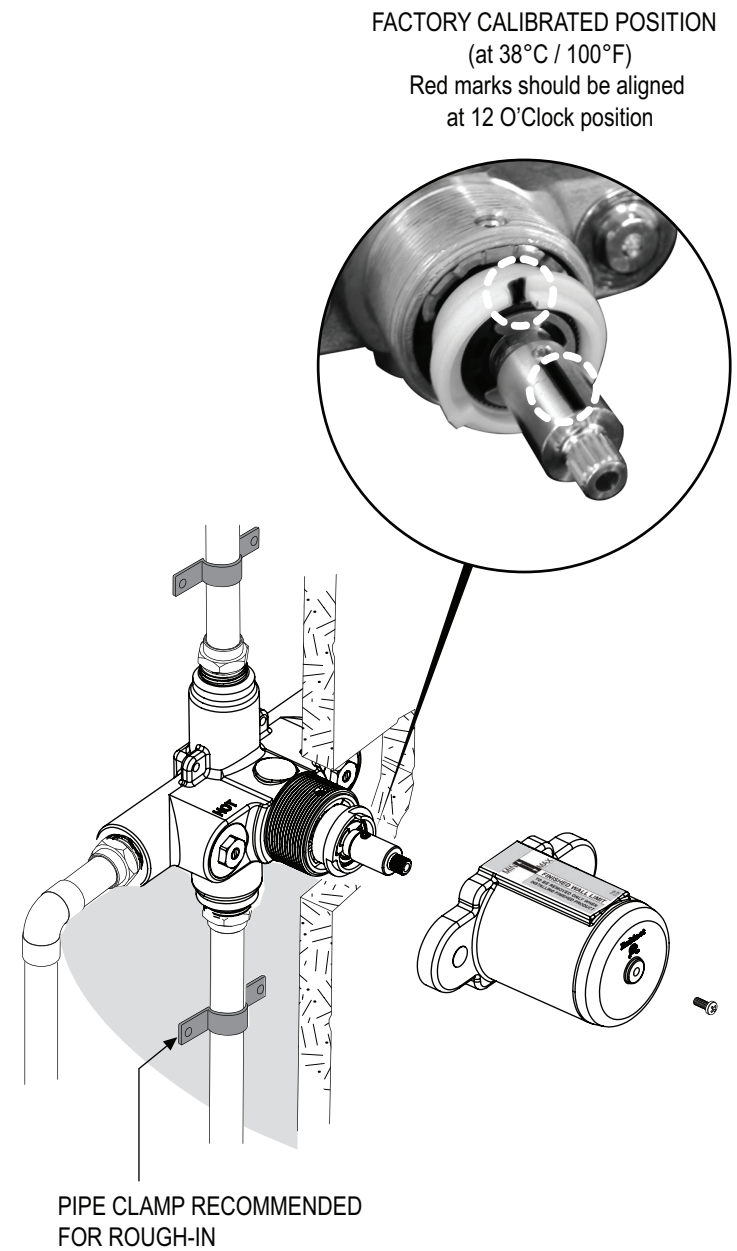

*** IF PEX PIPING IS TO BE USED, DO NOT USE PEX WITH A DIAMETER OF LESS THAN 3/4" FOR MAXIMUM FLOW FROM THE VALVE.**