



Effective: March 5, 2021

# Submittal Data Information

## 0018e® ECM High-Efficiency Circulator

101-207

Supersedes: December 27, 2018

Job: \_\_\_\_\_ Engineer: \_\_\_\_\_ Contractor: \_\_\_\_\_ Rep: \_\_\_\_\_

ITEM NO.	MODEL NO.	

### Specifications

- Max. Shut-off Head: 18 feet
- Max. Flow: 16 gpm
- Max. Operating Pressure:
  - Cast Iron: 125 psi (8.6 bar)
  - Stainless Steel: 150 psi (10 bar)
- Max. Water Temp: 230°F (110°C)
- Min. Water Temp: 36°F (2°C)
- Electrical specifications:
  - Voltage: 120V, 60 Hz
  - Single phase
  - Max. Operating Power: 44W
  - Max. AMP Rating: 0.54
- Cast iron casing suitable for closed loop systems only
- Stainless steel casing suitable for potable water or open systems
- Not suitable for chilled water
- Taco circulator pumps are for indoor use only
- Acceptable for use with water or maximum of 50% water/glycol solution

### Materials of Construction:

Casing: ..... Cast Iron or  
Stainless Steel

Stator Housing: ..... Composite

Cartridge: ..... Composite

Impeller: ..... Composite

Shaft: ..... Ceramic

Bearings: ..... Carbon

Thrust Bearing: ..... Ceramic

O-Ring & Gaskets: ..... EPDM

### Applications

The 0018e is a variable speed, high-efficiency wet rotor circulator with an ECM permanent magnet motor. Operating modes include infinitely variable fixed speed, constant pressure, proportional pressure or self-adjusting activeADAPT®. Stainless Steel models for use in potable water systems for domestic water recirculation. The 0018e is not suitable for chilled water systems.

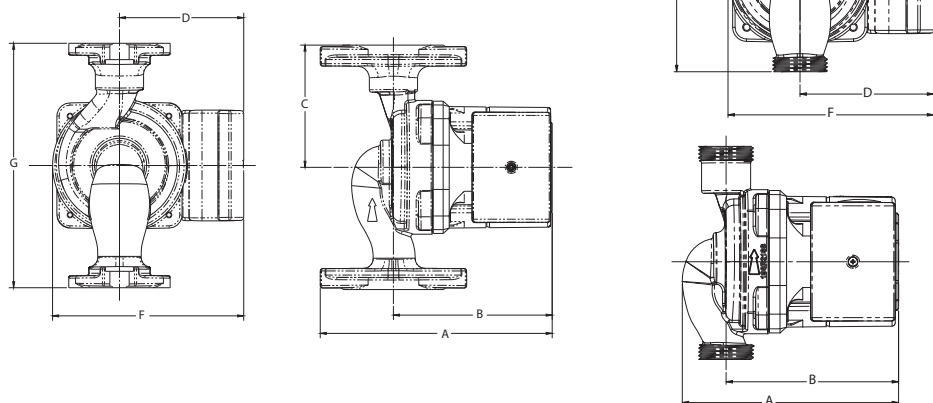

### Pump Dimensions & Weights

Model Number	Connection Type	Casing	A		B		C		D		F		G		Ship Wt.	
			in.	mm	in.	mm	in.	mm	in.	mm	in.	mm	in.	mm	lbs.	Kg
0018e-2F2	Standard	CI	6	152	4-1/8	104	3-3/16	80	3-1/4	82	5	126	6-3/8	161	5.8	2.6
0018e-2F4	Universal	CI	6	152	4-1/8	104	3-3/16	80	3-1/4	82	5	126	6-3/8	161	6	3.7
0018e-SF4	Universal	SS	6	152	4-1/8	104	3-3/16	80	3-1/4	82	5	126	6-3/8	161	5.5	2.5
0018e-SU	Union	SS	5-1/6	131	4-1/8	104	3-3/16	80	3-1/4	82	5	126	5-1/8	130	4.6	2.1

### Connection Types

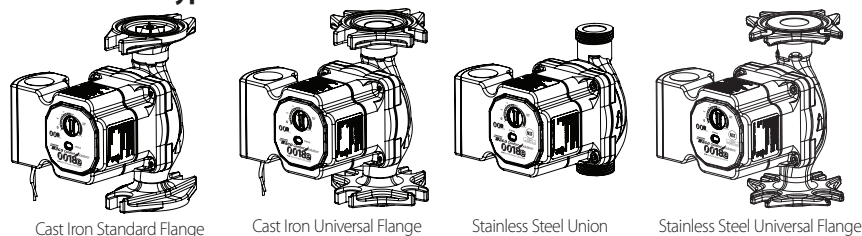

### Electrical Data

Model	Volts	Hz	Ph	Max. Amps	Max. Watts	RPM
All Models	120	60	1	.54	44	1590-4830
Motor Type	ECM, Permanent Magnet, Thermally Protected					



Certified to  
NSF/ANSI 61 & 372



Stainless Steel  
models only



Taco, Inc., 1160 Cranston Street, Cranston, RI 02920 | Tel: (401) 942-8000 | FAX: (401) 942-2360

Taco (Canada), Ltd., 8450 Lawson Road, Suite #3, Milton, Ontario L9T 0J8 | Tel: (905) 564-9422 | FAX: (905) 564-9436

Visit our web site: [www.TacoComfort.com](http://www.TacoComfort.com) | ©2021 Taco, Inc.

