

Installation Instructions

for use by heating contractor

VIESSMANN

Control Console, Part No. 7427 419, 7427 420 for Vitodens 100, Series WB1B

Please file in Service Binder

Safety and Installation Requirements

Please ensure that these instructions are read and understood before installation. Failure to comply with the instructions listed below can cause **product/property damage, severe personal injury, and/or loss of life.**

Working on the equipment

The installation, adjustment, service and maintenance of this product must be done by a **licensed professional heating contractor** who is qualified and experienced in the installation, service, and maintenance of hot water boilers. There are no user serviceable parts on the boiler, burner or control.

Ensure **main power** supply to equipment, the heating system, and all external controls has been **deactivated**.

Close main fuel supply valve.

Take precautions in both instances to avoid accidental activation of power during service work.

It is not permissible to perform service work on any component part without ensuring safe operation of the heating system. When replacing parts, use original Viessmann or Viessmann approved replacement parts.

Removing the control unit

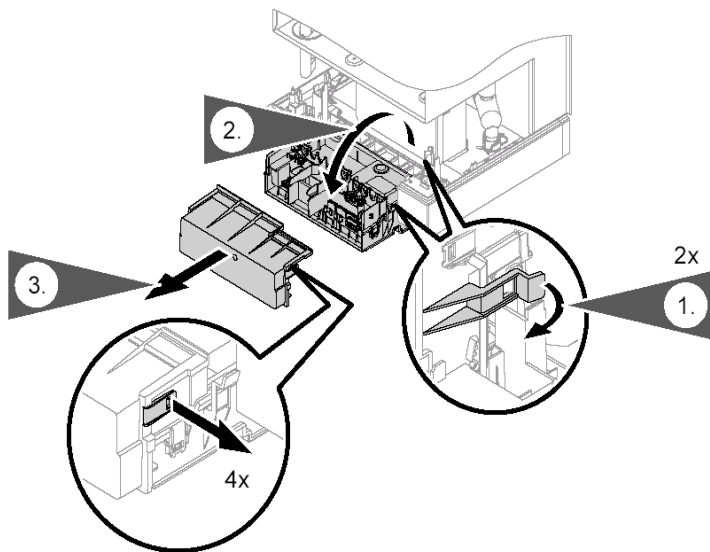

1. Loosen the screws underneath the boiler but do not remove them. Remove the cover.
2. Pull tabs outwards.
3. Flip control console down.
4. Remove cover by releasing tabs.

IMPORTANT

Both the control unit and the power/pump module (connection box) have labels and stickers containing important information. Read and follow their respective instructions.

IMPORTANT

The ON / OFF switch located on the boiler does not disconnect power to power/pump module (connection box), therefore the main service switch or breaker must be turned off.

Note on connection of accessories



For other required installation steps, please reference the Installation Instructions for the accessory part.

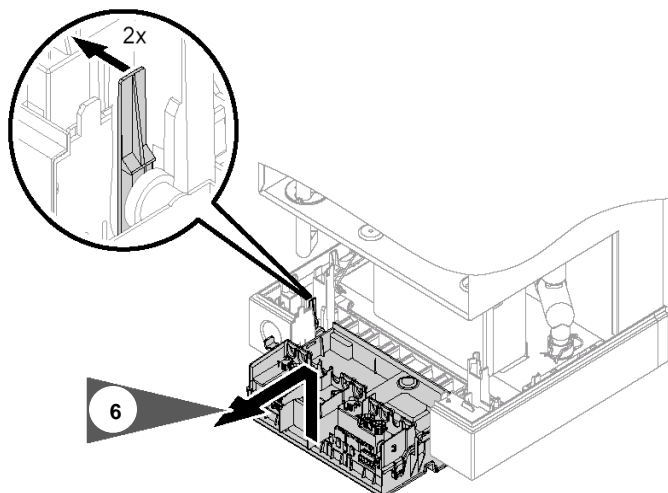

5. Disconnect all wiring connections.

6. Push tabs outwards and remove control UP and OUT.

7. To install new control reverse above procedure.



Please reference the Installation & Service Instructions for:

- Programming the control unit if required
- Conversion for propane operation
- High altitude operation

