

AQUOR® PEX Inlet (F1960)

Designed for use with cold-expansion PEX tubing.

Allows the tube and ring to annularly constrict around the sealing barb of the fitting - thereby achieving an air-tight pressure seal.

Elbow inlet can be safely positioned in any direction.

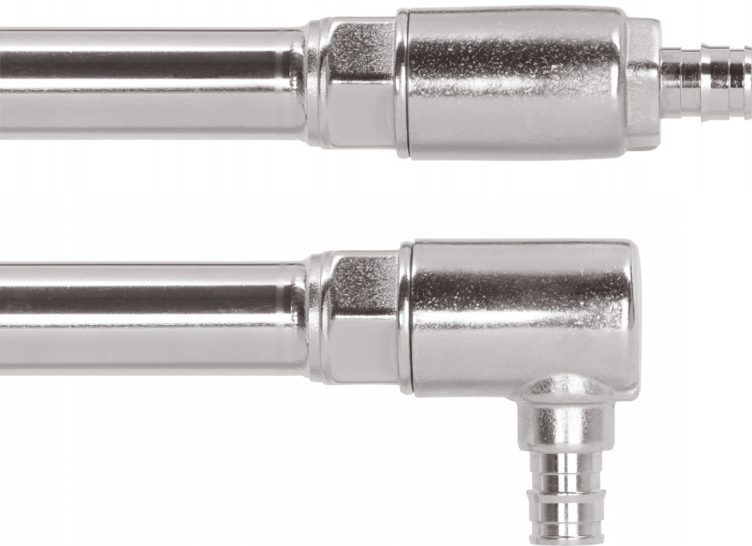

- 1) Attach inlet to hydrant body by hand. Do not use power tools.
- 2) Elbow inlet: fully tighten, then back off up to 360° to orient.
- 2) Insert into expanded PEX tubing and cold-expansion ring.
- 3) Allow tubing to constrict fully per manufacturer's instructions.
- 4) Pressure-test before use.

- Compatible with ASTM F1960 PEX expansion connections.
- Intended for use with self-rotating power expansion tool.
- Adhere to your PEX manufacturer's installation instructions.
- Pressure-test all joints before use.
- Includes internal stainless steel valve spring.
- Material: 316L Stainless Steel
- Maximum temperature: 140° F
- Maximum pressure: 125 PSI

Compatibility**WORKS WITH:**

- ✓ Aquor Wall Hydrants (V1, V1+, V2, V2+)
- ✓ Aquor RV City Water Inlet
- ✓ Aquor Marine Deckwash
- ✓ Aquor Universal Outlet
- ✗ Aquor Ground Hydrants

Available Models:

INL-1-PEX



INL-90-PEX

- ☐ **INL-1-PEX:** Straight Inlet, for 1/2" PEX
- ☐ **INL-90-PEX:** 90° Elbow Inlet, for 1/2" PEX

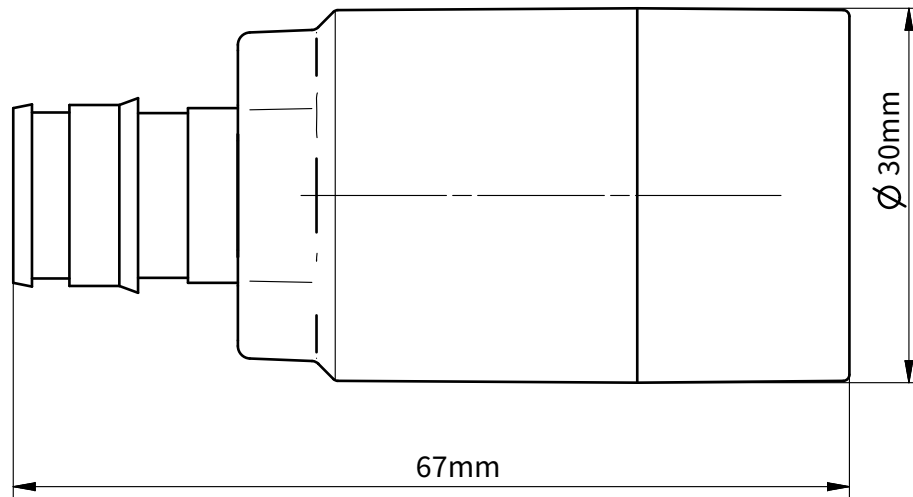

Dimensions per ASTM F1960:

A: Ftg Inside diameter	0.385" min
B: Ftg Upper barb diameter	0.571" min 0.579" max
C: Ftg Lower barb diameter	0.610" min 0.618" max
D: Fitting end length	0.689" min 0.749" max
E: Ring inside diameter	0.633" +/- 0.003
F: Ring wall thickness	0.123" +/- 0.005
G: Ring overall height	0.630" +/- 0.020

