



PRICE LIST

EFFECTIVE: APRIL 1, 2021



THE ENGINEERED ACRYLIC ADVANTAGES

- Beautiful High Gloss Finish
- Warm to the Touch
- Easy to Clean
- Best Choice for Durability
- Scratch and Stain Resistant
- Environmentally Responsible





mirolin.com

THE MIROLIN® BRAND

The Mirolin Brand has a reputation for enduring quality, innovation and value through an extensive and complete product assortment. Our one piece and multi piece designs offer a bathing fixture solution to meet any home renovation or new construction application.

Our products will be part of your day-to-day life for years to come, which is why we are constantly striving to offer premium innovative bath and shower products.

Our acrylic products deliver quality and durability with trend setting designs that offer great value for generations of enjoyment.

OUR STORY

For four decades, the Mirolin brand has grown and evolved into a Canadian leader, manufacturing innovative and trend setting acrylic tub and shower products.

With our manufacturing facility in Ontario, the Mirolin brand is a national manufacturer in the acrylic tub and shower industry; proudly servicing the new home construction, home improvement and renovation markets Canada-wide. We offer a full product assortment to suit the needs of our customer base coast to coast.

A HISTORY OF SERVICE & EXCELLENCE

Service Excellence

The Mirolin brand prides itself on providing exceptional customer service and after sales support. Our team are highly skilled professionals who deliver product knowledge and training coupled with our dedicated in-house service technicians. We are committed to going above and beyond for your business.

Our Commitment to Quality

The Mirolin brand is committed to on-going improvement and sustainable, ethical practices. Our goals are continued growth, commitment to quality and consistently exceeding our customers' expectations.

At Mirolin, we have made a conscious choice to deliver a better product. We don't compromise on quality because as consumers ourselves, we wouldn't expect anything less.



Embrace relaxation and bathing comfort in the bath.

Product availability and configurations are subject to change without notice. Prices are subject to change without notice.
Please contact a Customer Service Representative to confirm availability.

BATHS FOR THIS GENERATION AND THE NEXT

FREESTANDING BATHTUBS | SKIRTED & ALCOVE TUBS | TUB SHOWERS
SHOWER DOORS & BASES | BARRIER FREE BATHING SOLUTIONS

TABLE OF CONTENTS

One-Piece		Skirted Baths		Tub Showers		Shower Bases	
Freestanding Baths		Tucson™	14	Liberty™	28	Strada™	46
Ishya™	4	Phoenix™	15	Hampton™	29	Sorrento™	49
Pria™	5	Phoenix 2™	15	Tribeca™	29	Accessible	
Calago™	5	Phoenix 3™	15	Parker™ 20	30	Access™ 66	50
Zahra™	6	Prescott™	16	Parker™ 16	31	Riverdale™	51
Sussex™	6	Adora™	16	Empire™	32	Parker™ Free Living	
Nuan™	7	Austin™	17	Sutton™	32	Light	52
Ilusa™	7	Austin™ 16	17	Belaire™	33	Madison™ Free Living	
Mistaya™	8	Corra™	18			Standard	53
Skye™	8			Showers		Options &	
Carrera™	9	Alcove Baths		Madison™ 5	35	Accessories	54
Hessa™	9	Gryphon™	19	Madison™ 4	36	Product Features	
Slate™	10	Salina™	20	Madison™ 3	37	Free Living Options	56
		Aura™	20	Melrose™ 5	38	Hydrotherapy	57
Two-Piece		Envy™	21	Melrose™ 4	39	Snap-Fit® System	58
Freestanding Baths		Amalfi™	21	Melrose™ 3	39	Latch Fit System	58
Demi™	10			Sorrento™ 38	40	Integral Tile Flange	59
Cari™	11	Drop-in Baths				Above Floor Rough-In	59
Brooke™	11	Bliss™	22	Shower Doors		Terms & Conditions	60
Cruz™	12	Marlowe™	23	Bypass Series	42		
Beacon™	12	Kalm™	23	Swing Door Series	43		
Sable™	13	Hudson™ 5	24	Retrofit Shower Series	43		
		Hudson™ 6	24	Roll Top Series	44		
		Adda™	25	Corner Shower Series	45		
		Mella™	25				
		Pur™	26				
		Po™ 2	26				
		Soho™ 1	27				

FREESTANDING BATHS

A collection of acrylic freestanding baths that inspire luxury with sleek contemporary lines and alluring silhouettes. Tempting soaker baths in modern and traditional designs that will transform and inspire your bathing experience.

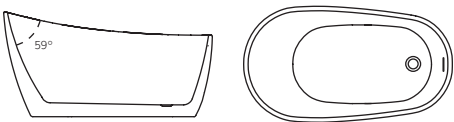

ISHYA™

SlimLine™ Raised Neck Rest Soaker 59 ½" x 29" x 27 ½"	CFI019	\$1,905
SlimLine™ Raised Neck Rest Soaker 67 ½" x 29" x 27 ½"	CFI020	\$1,975

- Features & Benefits**
- Vacuum formed acrylic reinforced with fiberglass
 - Scratch, stain and fade resistant high gloss finish
 - Includes integral white powder coated pop up drain and slotted overflow
 - Includes a steel frame with self levelling feet
 - End drain

General Specifications	CFI019	CFI020
Average weight	86 lbs / 39 kg	94 lbs / 43 kg
Bathing well at bottom	21" x 42"	21" x 49"
Capacity drain to overflow	44 gal / 200 L	55 gal / 250 L
Water depth drain to overflow	14 ¼"	14 ¾"
Drain opening (dia.)	2"	2"
Overflow opening	4" x ¼"	4" x ¼"
Drain to floor clearance	4 ½"	3 ¾"
Colours available	White	White



ONE-PIECE



PRIA™

SlimLine™ Raised Neck Rest Soaker

CF1023

\$2,165

Features & Benefits

- Vacuum formed acrylic reinforced with fiberglass
- Scratch, stain and fade resistant high gloss finish
- Includes integral white powder coated pop up drain and slotted overflow
- Includes a steel frame with self levelling feet
- End drain

General Specifications

Average weight	108 lbs / 49 kg
Bathing well at bottom	18 ¼" x 41"
Capacity drain to overflow	61 gal / 275 L
Water depth drain to overflow	14"
Drain opening (dia.)	2"
Overflow opening	4" x ¼"
Drain to floor clearance	2 ½"
Colours available	White



ONE-PIECE



CALAGO™

Raised Neck Rest Soaker

CF1024

\$1,975

59 ¾" x 31 ½" x 30 ½"

Features & Benefits

- Vacuum formed acrylic reinforced with fiberglass
- Scratch, stain and fade resistant high gloss finish
- Includes integral white powder coated pop up drain and slotted overflow
- Accepts deck mounted faucet
- Includes a steel frame with self levelling feet
- End drain

General Specifications

Average weight	96 lbs / 44 kg
Bathing well at bottom	21" x 38 ½"
Capacity drain to overflow	44 gal / 200 L
Water depth drain to overflow	15 ½"
Drain opening (dia.)	2"
Overflow opening	4" x ¼"
Drain to floor clearance	3"
Colours available	White



ONE-PIECE



ZAHRA™

SlimLine™ Raised Neck Rest Soaker **CF1025** **\$2,045**
67" x 31 ¼" x 26 ½"

- Features & Benefits**
- Vacuum formed acrylic reinforced with fiberglass
 - Scratch, stain and fade resistant high gloss finish
 - Includes integral white powder coated pop up drain and slotted overflow
 - Includes a steel frame with self levelling feet
 - End drain

General Specifications	
Average weight	97 lbs / 44 kg
Bathing well at bottom	23 5⁄8" x 43"
Capacity drain to overflow	48 gal / 220 L
Water depth drain to overflow	14 1⁄8"
Drain opening (dia.)	2"
Overflow opening	4" x 1⁄4"
Drain to floor clearance	3 3⁄4"
Colours available	White



ONE-PIECE



SUSSEX™

SlimLine™ Raised Neck Rest Soaker **CF1015** **\$2,095**
70 ¾" x 31 ½" x 27"

- Features & Benefits**
- Includes integral white powder coated pop up drain and slotted overflow
 - Includes a chrome integral pop up drain and slotted overflow
 - Includes steel frame and levelling feet
 - Centre drain

General Specifications	
Average weight	99 lbs / 45 kg
Bathing well at bottom	21 ½" x 50 ½"
Capacity drain to overflow	99 gal / 375 L
Water depth drain to overflow	15 ½"
Drain opening (dia.)	2"
Overflow opening	3 1⁄8" x 3⁄8"
Drain to floor clearance	3 ½"
Colours available	White



ONE-PIECE



NUAN™

SlimLine™ Soaker

59" x 31" x 23 ¾"

CF1028

\$1,905

SlimLine™ Soaker

67 ¼" x 31" x 23 ¾"

CF1029

\$1,975

Features & Benefits

- Vacuum formed acrylic reinforced with fiberglass
- Scratch, stain and fade resistant high gloss finish
- Includes integral white powder coated pop up drain and slotted overflow
- Includes a steel frame with self levelling feet
- Centre drain

General Specifications	CF1028	CF1029
Average weight	95 lbs / 43 kg	102 lbs / 46 kg
Bathing well at bottom	22" x 38 ½"	22" x 46 ½"
Capacity drain to overflow	57 gal / 259 L	63 gal / 286 L
Water depth drain to overflow	15 ¾"	15 ¾"
Drain opening (dia.)	2"	2"
Overflow opening	4" x ¼"	4" x ¼"
Drain to floor clearance	3 ½"	4"
Colours available	White	White



ONE-PIECE



ILUSA™

SlimLine™ Soaker

59 ½" x 30" x 22"

CF1018

\$1,870

Features & Benefits

- Includes integral white powder coated pop up drain and slotted overflow
- Includes a chrome integral pop up drain and slotted overflow
- Includes steel frame and levelling feet
- Centre drain

General Specifications

Average weight	114 lbs / 52 kg
Bathing well at bottom	21" x 47"
Capacity drain to overflow	61 gal / 232 L
Water depth drain to overflow	14 ¾"
Drain opening (dia.)	2"
Overflow opening	3 ½" x ¾"
Drain to floor clearance	3 ¼"
Colours available	White



MISTAYA™

SlimLine™ Soaker 59" x 31 ½" x 23 ½"	CF1021	\$1,905
SlimLine™ Soaker 66 ¾" x 31 ½" x 23 ¾"	CF1022	\$1,975

- Features & Benefits**
- Vacuum formed acrylic reinforced with fiberglass
 - Scratch, stain and fade resistant high gloss finish
 - Includes integral white powder coated pop up drain and slotted overflow
 - Includes a steel frame with self levelling feet
 - Centre drain

General Specifications	CF1021	CF1022
Average weight	92 lbs / 42 kg	101 lbs / 46 kg
Bathing well at bottom	20 ½" x 39 ½"	20 ½" x 48"
Capacity drain to overflow	60 gal / 274 L	70 gal / 320 L
Water depth drain to overflow	15 ¾"	15 ¾"
Drain opening (dia.)	2"	2"
Overflow opening	4" x ¼"	4" x ¼"
Drain to floor clearance	3 ½"	3 ½"
Colours available	White	White



SKYE™

SlimLine™ Soaker 66 ½" x 29 ⅝" x 23 ¾"	CF1012	\$1,930
--	---------------	----------------

- Features & Benefits**
- Includes integral white powder coated pop up drain and slotted overflow
 - Includes a chrome integral pop up drain and slotted overflow
 - Includes steel frame and levelling feet
 - Centre drain

General Specifications	
Average weight	108 lbs / 49 kg
Bathing well at bottom	18 ½" x 41 ½"
Capacity drain to overflow	79 gal / 300 L
Water depth drain to overflow	15 ¾"
Drain opening (dia.)	2"
Overflow opening	3 ⅝" x ⅜"
Drain to floor clearance	4 ⅝"
Colours available	White

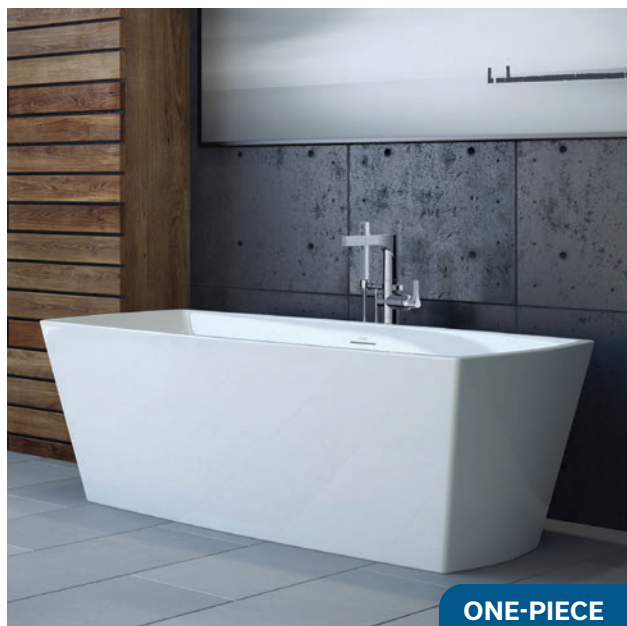
**ONE-PIECE**

CARRERA™

SlimLine™ Soaker

67" x 31" x 24"

CFI014

\$1,930

Features & Benefits

- Includes integral white powder coated pop up drain and slotted overflow
- Includes a chrome integral pop up drain and slotted overflow
- Includes steel frame and levelling feet
- Centre drain

General Specifications

Average weight	89 lbs / 40 kg
Bathing well at bottom	19" x 44"
Capacity drain to overflow	88 gal / 333 L
Water depth drain to overflow	16"
Drain opening (dia.)	2"
Overflow opening	3 1/8" x 3/8"
Drain to floor clearance	4 1/2"
Colours available	White

**ONE-PIECE**

HESSA™

Soaker

59" x 31 1/2" x 23 3/4"

CFI026

\$1,905

Soaker

67" x 31 1/4" x 23 1/2"

CFI027

\$1,975

Features & Benefits

- Vacuum formed acrylic reinforced with fiberglass
- Scratch, stain and fade resistant high gloss finish
- Includes integral white powder coated pop up drain and slotted overflow
- Accepts deck mounted faucet
- Includes a steel frame with self levelling feet
- Centre drain

General Specifications

	CFI026	CFI027
Average weight	94 lbs / 43 kg	102 lbs / 46 kg
Bathing well at bottom	20" x 39"	20" x 47 1/2"
Capacity drain to overflow	58 gal / 220 L	63 gal / 238 L
Water depth drain to overflow	15 1/4"	15 3/8"
Drain opening (dia.)	2"	2"
Overflow opening	4" x 1/4"	4" x 1/4"
Drain to floor clearance	3 1/2"	3 1/2"
Colours available	White	White



SLATE™

SlimLine™ Soaker

CF1016 \$1,930

66 ¾" x 31 ½" x 24"

Features & Benefits

- Includes integral white powder coated pop up drain and slotted overflow
- Includes a chrome integral pop up drain and slotted overflow
- Includes steel frame and levelling feet
- Centre drain

General Specifications

Average weight	93 lbs / 42 kg
Bathing well at bottom	21" x 47 ½"
Capacity drain to overflow	94 gal / 355 L
Water depth drain to overflow	15 ¾"
Drain opening (dia.)	2"
Overflow opening	3 ⅛" x ¾"
Drain to floor clearance	4 ¾"
Colours available	White

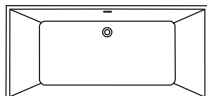
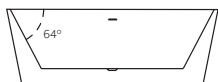

DEMI™

Soaker

CF2007 \$2,025

60" x 32" x 22"

Features & Benefits

- Installation friendly two piece design
- Accepts deck mounted faucet
- Includes a chrome integral pop up drain and rectangular overflow
- Brushed Nickel drain and overflow covers available (see Accessory page 54)
- End drain
- Includes levelling feet

General Specifications

Average weight	90 lbs / 41 kg
Bathing well at bottom	43" x 20"
Capacity drain to overflow	51 ½ gal / 195 L
Water depth drain to overflow	16"
Drain opening (dia.)	2"
Overflow opening	2 ¼" x ½"
Drain to floor clearance	3 ¼"
Colours available	White

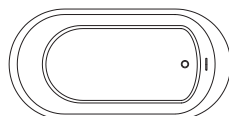
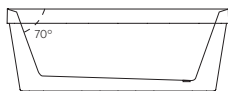

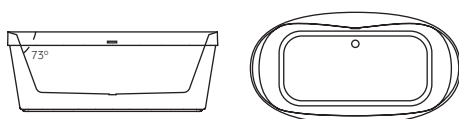

CARI™

Soaker

60" x 32" x 22"

CF2006

\$2,025

Features & Benefits

- Installation friendly two piece design
- Accepts deck mounted faucet
- Includes a chrome integral pop up drain and rectangular overflow
- Brushed Nickel drain and overflow covers available (see Accessory page 54)
- Centre drain
- Includes levelling feet

General Specifications

Average weight	95 lbs / 43 kg
Bathing well at bottom	21" x 45"
Capacity drain to overflow	60 gal / 227 L
Water depth drain to overflow	16"
Drain opening (dia.)	2"
Overflow opening	2 ¼" x ½"
Drain to floor clearance	3 ¼"
Colours available	White

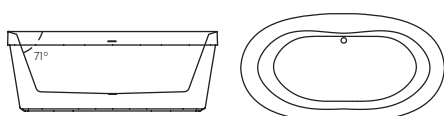

BROOKE™

Soaker

68" x 36" x 23"

CF2002

\$2,140

Features & Benefits

- Installation friendly two piece design
- Accepts deck mounted faucet
- Includes a chrome integral pop up drain and rectangular overflow
- Brushed Nickel drain and overflow covers available (see Accessory page 54)
- Centre drain
- Includes levelling feet

General Specifications

Average weight	105 lbs / 48 kg
Bathing well at bottom	49" x 24"
Capacity drain to overflow	77 gal / 291 L
Water depth drain to overflow	16 ½"
Drain opening (dia.)	2"
Overflow opening	2 ¼" x ½"
Drain to floor clearance	3 ¼"
Colours available	White

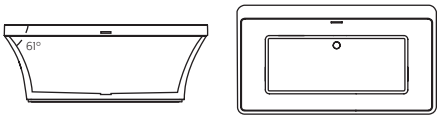

CRUZ™

Soaker **CF2005** **\$2,135**
60" x 32" x 22"

- Features & Benefits**
- Installation friendly two piece design
 - Accepts deck mounted faucet
 - Includes a chrome integral pop up drain and rectangular overflow
 - Brushed Nickel drain and overflow covers available (see Accessory page 54)
 - Centre drain
 - Includes levelling feet

General Specifications	
Average weight	91 lbs / 41 kg
Bathing well at bottom	43 ½" x 19"
Capacity drain to overflow	51 gal / 193 L
Water depth drain to overflow	15 ¾"
Drain opening (dia.)	2"
Overflow opening	2 ¼" x ½"
Drain to floor clearance	3 ¼"
Colours available	White

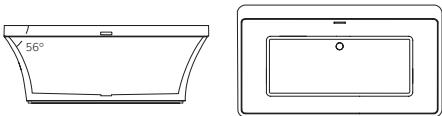

BEACON™

Soaker **CF2001** **\$2,240**
67" x 36" x 23"

- Features & Benefits**
- Installation friendly two piece design
 - Accepts deck mounted faucet
 - Includes a chrome integral pop up drain and rectangular overflow
 - Brushed Nickel drain and overflow covers available (see Accessory page 54)
 - Centre drain
 - Includes levelling feet

General Specifications	
Average weight	98 lbs / 44 kg
Bathing well at bottom	48" x 20 ½"
Capacity drain to overflow	78 gal / 295 L
Water depth drain to overflow	16"
Drain opening (dia.)	2"
Overflow opening	2 ¼" x ½"
Drain to floor clearance	3 ¼"
Colours available	White

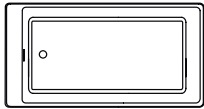
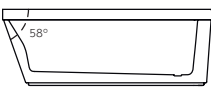

SABLE™

Soaker

59 ¾" x 31 ¾" x 22"

CF2012

\$2,135

Features & Benefits

- Installation friendly two piece design
- Accepts deck mounted faucet
- Includes a chrome integral pop up drain and rectangular overflow
- Brushed Nickel drain and overflow covers available (see Accessory page 54)
- End drain
- Includes levelling feet

General Specifications

Average weight	85 lbs / 39 kg
Bathing well at bottom	21 ½" x 44"
Capacity drain to overflow	70 gal / 264 L
Water depth drain to overflow	15 ¼"
Drain opening (dia.)	2"
Overflow opening	2 ¼" x ½"
Drain to floor clearance	3 ¼"
Colours available	White

SKIRTED BATHS

Stylish and convenient, Mirolin® acrylic skirted baths come in a variety of designs and sizes. All skirted baths are equipped with a built-in tile flange and are also available with various whirlpool options.



See page 59 for further information



TUCSON™

60" x 32" x 20"

LEFT OR RIGHT IS DETERMINED BY PLUMBING.

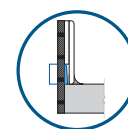

Integrated Tile Flange

Soaker – Left Drain	TA6032L	\$725
Soaker – Right Drain	TA6032R	\$725
Whirlpool – Left Drain	TAS6032LAW	\$2,125
Whirlpool – Right Drain	TAS6032RAW	\$2,125

6 side jets and 2 foot jets

Features & Benefits

- Spacious bathing well
- Integral tile flange
- Sloped lumbar support
- Available in left/right configuration
- Removable front access panel on whirlpool models
- Convenient dual armrests
- Above floor rough-in
- Patterned bottom

General Specifications

Bathing well at bottom	21 1/2" x 45 1/2"
Capacity drain to overflow	218 L
Water depth drain to overflow	13"
Overflow opening	2 1/2"
Drain to floor clearance	3"
Colours available	White
Pump/motor (Whirlpool only)	3/4 HP / 75 AMP / 120V

Whirlpool Options

Factory Installed Whirlpool Heater	\$ 340
Upgrade to Polished Chrome	\$ 235
Upgrade to Brushed Nickel	\$ 395

Doors for 60" Bathtub

Roll Top Bathtub Door	
RT60BTPS (Plain, Silver)	\$ 1,110
Bypass Bathtub Door	
BDLT60PS (Plain, Silver)	\$ 825
BDLT60MS (Mystique, Silver)	\$ 890



Features & Benefits

- Spacious bathing well
- Integral tile flange
- Sloped lumbar support
- Convenient dual armrests
- Above floor rough-in
- Available in left/right configuration
- Removable front access panel on whirlpool models
- Patterned bottom

Whirlpool Options

Factory Installed Whirlpool Heater	\$ 340
Upgrade to Polished Chrome	\$ 235
Upgrade to Brushed Nickel	\$ 395

Doors for 60" Bathtub

Roll Top Bathtub Door	
RT60BTPS (Plain, Silver)	\$ 1,110
Bypass Bathtub Door	
BDLT60PS (Plain, Silver)	\$ 825
BDLT60MS (Mystique, Silver)	\$ 890

PHOENIX™

60" x 30" x 20"

LEFT OR RIGHT IS DETERMINED BY PLUMBING.

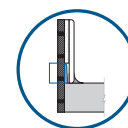

Integrated
Tile Flange

Soaker – Left Drain	PA6030L	\$680
Soaker – Right Drain	PA6030R	\$680
Whirlpool – Left Drain	PAS6030LAW	\$2,020
Whirlpool – Right Drain	PAS6030RAW	\$2,020

6 side jets and 2 foot jets

General Specifications

Bathing well at bottom	21 1/2" x 45 1/2"
Capacity drain to overflow	218 L
Water depth drain to overflow	13"
Overflow opening	2 1/2"
Drain to floor clearance	3"
Colours available	White
Pump/motor (Whirlpool only)	3/4 HP / 7.5 AMP / 120V

PHOENIX™ 2

66" x 32" x 20"

LEFT OR RIGHT IS DETERMINED BY PLUMBING.

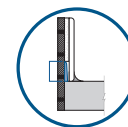

Integrated
Tile Flange

Soaker – Left Drain	PA6632L	\$860
Soaker – Right Drain	PA6632R	\$860

General Specifications

Bathing well at bottom	23" x 50"
Capacity drain to overflow	236 L
Water depth drain to overflow	12 3/4"
Overflow opening	2 1/2"
Drain to floor clearance	3"
Colours available	White

PHOENIX™ 3

72" x 34" x 20"

LEFT OR RIGHT IS DETERMINED BY PLUMBING.

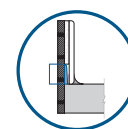

Integrated
Tile Flange

Soaker – Left Drain	PA7234L	\$1,015
Soaker – Right Drain	PA7234R	\$1,015
Whirlpool – Left Drain	PAS7234LAW	\$2,450
Whirlpool – Right Drain	PAS7234RAW	\$2,450

6 side jets and 2 foot jets

General Specifications

Bathing well at bottom	24" x 53"
Capacity drain to overflow	291 L
Water depth drain to overflow	13"
Overflow opening	2 1/2"
Drain to floor clearance	3"
Colours available	White
Pump/motor (Whirlpool only)	3/4 HP / 7.5 AMP / 120V



PRESCOTT™

60" x 30" x 20"

LEFT OR RIGHT IS DETERMINED BY PLUMBING.

Soaker – Left Drain

Soaker – Right Drain

PS6031L

\$705

PS6031R

\$705

Features & Benefits

- Integral tile flange
- Sloped lumbar support
- Convenient dual armrests
- Above floor rough-in
- Available in left/right configuration
- Raised neck rest
- Patterned bottom

General Specifications

Bathing well at bottom	19" x 45"
Capacity drain to overflow	200 L
Water depth drain to overflow	13"
Overflow opening	2 ½"
Drain to floor clearance	3 ¼"
Colours available	White

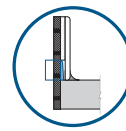

Integrated Tile Flange

Doors for 60" Bathtub

Roll Top Bathtub Door

RT60BTPS (Plain, Silver) \$ 1,110

Bypass Bathtub Door

BDLT60PS (Plain, Silver) \$ 825

BDLT60MS (Mystique, Silver) \$ 890

ADORA™

60" x 32" x 20"

LEFT OR RIGHT IS DETERMINED BY PLUMBING.

Soaker – Left Drain

Soaker – Right Drain

BO62L

\$1,010

BO62R

\$1,010

Features & Benefits

- Integral tile flange
- Sloped lumbar support
- Above floor rough-in
- Available in left/right configuration
- Patterned bottom
- Minimalist design

General Specifications

Bathing well at bottom	23" x 45"
Capacity drain to overflow	218 L
Water depth drain to overflow	12 ⅝"
Overflow opening	2 ½"
Drain to floor clearance	3"
Colours available	White

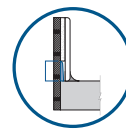

Integrated Tile Flange



Doors for 60" Bathtub

Roll Top Bathtub Door

RT60BTPS (Plain, Silver) \$ 1,110

Bypass Bathtub Door

BDLT60PS (Plain, Silver) \$ 825

BDLT60MS (Mystique, Silver) \$ 890



Doors for 60" Bathtub

Roll Top Bathtub Door

RT60BTPS (Plain, Silver) \$ 1,110

Bypass Bathtub Door

BDLT60PS (Plain, Silver) \$ 825

BDLT60MS (Mystique, Silver) \$ 890

AUSTIN™

60" x 30" x 20"

LEFT OR RIGHT IS DETERMINED BY PLUMBING.

Soaker – Left Drain

Soaker – Right Drain

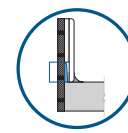

Integrated
Tile Flange

BO60L \$970

BO60R \$970

Features & Benefits

- Integral tile flange
- Sloped lumbar support
- Above floor rough-in
- Available in left/right configuration
- Patterned bottom
- Minimalist design

General Specifications

Bathing well at bottom	22 ½" x 46"
Capacity drain to overflow	218 L
Water depth drain to overflow	12 ⅝"
Overflow opening	2 ½"
Drain to floor clearance	3"
Colours available	White



AUSTIN™ 16

60" x 30" x 16"

LEFT OR RIGHT IS DETERMINED BY PLUMBING.

Soaker – Left Drain

Soaker – Right Drain

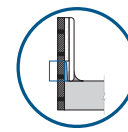

Integrated
Tile Flange

BO70L \$970

BO70R \$970

Features & Benefits

- Low 16" threshold for easy entry and exit
- Integral tile flange
- Sloped lumbar support
- Above floor rough-in
- Available in left/right configuration
- Patterned bottom
- Minimalist design

General Specifications

Bathing well at bottom	22" x 48"
Capacity drain to overflow	173 L
Water depth drain to overflow	10"
Overflow opening	2 ½"
Drain to floor clearance	3 ¼"
Colours available	White



CORRA™

66" x 34" x 20"
LEFT OR RIGHT IS DETERMINED BY PLUMBING.

Soaker – Left Drain
Soaker – Right Drain

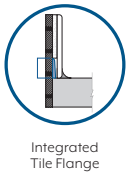

BO32L **\$1,250**
BO32R **\$1,250**

- Features & Benefits**
- Integral tile flange
 - Sloped lumbar support
 - Above floor rough-in
 - Available in left/right configuration
 - Patterned bottom
 - Minimalist design

General Specifications

Bathing well at bottom	23" x 49"
Capacity drain to overflow	250 L
Water depth drain to overflow	12 ½"
Overflow opening	2 ½"
Drain to floor clearance	3"
Colours available	White

ALCOVE BATHS

Offered in a wide range of sizes, each Mirolin® alcove bath is equipped with an integral tile flange for installation ease. These baths are ideal for any bathroom as their versatility makes for endless design options.



See page 59 for further information



Doors for 60" Bathtub

Roll Top Bathtub Door

RT60BTPS (Plain, Silver) \$ 1,110

Bypass Bathtub Door

BDLT60PS (Plain, Silver) \$ 825

BDLT60MS (Mystique, Silver) \$ 890

GRYPHON™

60" x 30" x 20"

LEFT OR RIGHT IS DETERMINED BY PLUMBING.

Soaker – Left Drain

Soaker – Right Drain

GR6030L

\$690

GR6030R

\$690

Features & Benefits

- Integral tile flange
- Sloped lumbar support
- Convenient dual armrests
- Above floor rough-in
- Available in left/right configuration
- Patterned bottom

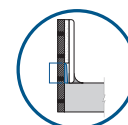

Integrated Tile Flange

General Specifications

Bathing well at bottom	21 ½" x 45 ½"
Capacity drain to overflow	218 L
Water depth drain to overflow	13"
Overflow opening	2 ½"
Drain to floor clearance	3"
Colours available	White



SALINA™

66" x 34" x 20"
LEFT OR RIGHT IS DETERMINED BY PLUMBING.

Soaker – Left Drain
Soaker – Right Drain

- Features & Benefits**
- Integral tile flange
 - Sloped lumbar support
 - Above floor rough-in
 - Available in left/right configuration
 - Patterned bottom

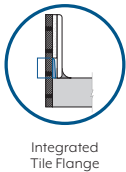

BO33L **\$1,260**
BO33R **\$1,260**

General Specifications

Bathing well at bottom	23" x 49"
Capacity drain to overflow	250 L
Water depth drain to overflow	12 ½"
Overflow opening	2 ½"
Drain to floor clearance	3"
Colours available	White



AURA™

60" x 30" x 20"
LEFT OR RIGHT IS DETERMINED BY PLUMBING.

Soaker – Left Drain
Soaker – Right Drain
Soaker – Bulk (8) – Left Drain
Soaker – Bulk (8) – Right Drain

- Features & Benefits**
- Integral tile flange
 - Sloped lumbar support
 - Above floor rough-in
 - Available in left/right configuration
 - Patterned bottom

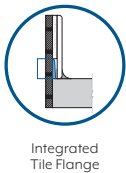

BO63L **\$985**
BO63R **\$985**
BO63L-8 **\$940**
BO63R-8 **\$940**

Doors for 60" Bathtub

Roll Top Bathtub Door	
RT60BTPS (Plain, Silver)	\$ 1,110
Bypass Bathtub Door	
BDLT60PS (Plain, Silver)	\$ 825
BDLT60MS (Mystique, Silver)	\$ 890

General Specifications

Bathing well at bottom	22 ½" x 46"
Capacity drain to overflow	218 L
Water depth drain to overflow	12 ⅝"
Overflow opening	2 ½"
Drain to floor clearance	3"
Colours available	White



ENVY™

60" x 30" x 22"

LEFT OR RIGHT IS DETERMINED BY PLUMBING.

SlimLine™ Soaker – Left Drain
SlimLine™ Soaker – Right Drain
SlimLine™ Soaker – Bulk (8) – Left Drain
SlimLine™ Soaker – Bulk (8) – Right Drain

BO69SL \$1,035
BO69SR \$1,035
BO69SL-8 \$990
BO69SR-8 \$990

Features & Benefits

- Integral tile flange
- Sloped lumbar support
- Above floor rough-in
- Ultra spacious bathing well
- Available in left/right configuration
- Patterned bottom
- Minimalist design

General Specifications

Bathing well at bottom	22" x 46 ½"
Capacity drain to overflow	286 L
Water depth drain to overflow	16 ½"
Overflow opening	2 ½"
Drain to floor clearance	2 ¾"
Colours available	White

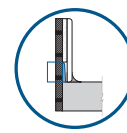

Integrated
Tile Flange



AMALFI™

60" x 32" x 20"

LEFT OR RIGHT IS DETERMINED BY PLUMBING.

Soaker – Left Drain
Soaker – Right Drain
Soaker – Bulk (8) – Left Drain
Soaker – Bulk (8) – Right Drain

BO64L \$1,020
BO64R \$1,020
BO64L-8 \$975
BO64R-8 \$975

Features & Benefits

- Integral tile flange
- Sloped lumbar support
- Above floor rough-in
- Available in left/right configuration
- Patterned bottom
- Minimalist design

General Specifications

Bathing well at bottom	23" x 45"
Capacity drain to overflow	218 L
Water depth drain to overflow	12 5/8"
Overflow opening	2 ½"
Drain to floor clearance	3"
Colours available	White

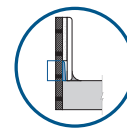

Integrated
Tile Flange

Doors for 60" Bathtub

Roll Top Bathtub Door
RT60BTPS (Plain, Silver) \$ 1,110

Bypass Bathtub Door
BDLT60PS (Plain, Silver) \$ 825
BDLT60MS (Mystique, Silver) \$ 890

DROP-IN BATHS

Mirolin® branded products include a vast collection of classic and elegant drop-in bath designs that will suit any décor. Drop in models are available as a timeless soaker bath or an invigorating whirlpool bath.



See page 59 for further information



Accessories
Universal Tile Flange Kit (see page 54)

BLISS™

60" x 32" x 20"

Soaker	BO672	\$820
Soaker – Bulk (8)	BO672-8	\$775

- Features & Benefits**
- Accepts deck mounted faucet
 - Sloped lumbar support
 - Above floor rough-in
 - Patterned bottom

General Specifications

Bathing well at bottom	21" x 43 ½"
Capacity drain to overflow	185 L
Water depth drain to overflow	12 ½"
Overflow opening	2 ½"
Drain to floor clearance	3"
Colours available	White



Accessories

Universal Tile Flange Kit (see page 54)

MARLOWE™

60" x 36" x 20"

Soaker

BO612

\$900

Soaker – Bulk (8)

BO612-8

\$850

Features & Benefits

- Accepts deck mounted faucet
- Sloped lumbar support
- Above floor rough-in
- Patterned bottom

General Specifications

Bathing well at bottom	22" x 43"
Capacity drain to overflow	236 L
Water depth drain to overflow	13"
Overflow opening	2 ½"
Drain to floor clearance	2 ¾"
Colours available	White



Accessories

Universal Tile Flange Kit (see page 54)

KALM™

72" x 36" x 20"

Soaker

BO942

\$1,215

Soaker – Bulk (8)

BO942-8

\$1,175

Features & Benefits

- Accepts deck mounted faucet
- Sloped lumbar support
- Above floor rough-in
- Patterned bottom

General Specifications

Bathing well at bottom	20" x 51"
Capacity drain to overflow	318 L
Water depth drain to overflow	13"
Overflow opening	2 ½"
Drain to floor clearance	2 ¾"
Colours available	White



Whirlpool Options

Factory Installed Whirlpool Heater	\$ 340
Upgrade to Polished Chrome	\$ 235
+ Single Back Jets Polished Chrome	\$ 95
Upgrade to Brushed Nickel	\$ 395
+ Single Back Jets Brushed Nickel	\$ 125

Accessories

Universal Tile Flange Kit (see page 54)

HUDSON™ 5

60" x 42" x 20"

Soaker	H6042	\$895
Soaker - Bulk (8)	H6042-8	\$850
Whirlpool	H6042AW	\$2,225
6 side jets and 2 foot jets		
Whirlpool – Back Jets	H6042BW	\$2,550
6 side jets, 2 foot jets and 5 spinner back jets		

Features & Benefits

- Accepts deck mounted faucet
- Sloped lumbar support
- Spacious bathing well
- Convenient dual armrests
- Above floor rough-in
- Patterned bottom

General Specifications

Bathing well at bottom	28" x 42"
Capacity drain to overflow	232 L
Water depth drain to overflow	12 ½"
Overflow opening	2 ½"
Drain to floor clearance	2 ¾"
Colours available	White
Pump/motor (Whirlpool only)	¾ HP / 75 AMP / 120V



Whirlpool Options

Factory Installed Whirlpool Heater	\$ 340
Upgrade to Polished Chrome	\$ 235
+ Single Back Jets Polished Chrome	\$ 95
Upgrade to Brushed Nickel	\$ 395
+ Single Back Jets Brushed Nickel	\$ 125

Accessories

Universal Tile Flange Kit (see page 54)

HUDSON™ 6

72" x 42" x 20"

Soaker	H7242	\$1,290
Soaker – Bulk (8)	H7242-8	\$1,250
Whirlpool	H7242AW	\$2,650
6 side jets and 2 foot jets		
Whirlpool – Back Jets	H7242BW	\$2,975
6 side jets, 2 foot jets and 5 spinner back jets		

Features & Benefits

- Accepts deck mounted faucet
- Sloped lumbar support
- Spacious bathing well
- Convenient dual armrests
- Above floor rough-in
- Patterned bottom

General Specifications

Bathing well at bottom	29" x 52"
Capacity drain to overflow	295 L
Water depth drain to overflow	12 ¾"
Overflow opening	2 ½"
Drain to floor clearance	2 ¾"
Colours available	White
Pump/motor (Whirlpool only)	¾ HP / 75 AMP / 120V



Whirlpool Options

Factory Installed Whirlpool Heater	\$ 340
Upgrade to Polished Chrome	\$ 330
Upgrade to Brushed Nickel	\$ 520

Accessories

Universal Tile Flange Kit (see page 54)

ADDA™

60" x 32" x 22"

Soaker

Soaker – Bulk (8)

BO652	\$955
BO652-8	\$915

Whirlpool – Back Jets

6 side jets, 2 foot jets and 5 spinner back jets

WB652	\$2,615
--------------	----------------

Features & Benefits

- 2" profile
- Allows for top, flush or under mount installation
- Accepts deck mounted faucet
- Sloped lumbar support
- Above floor rough-in
- Patterned bottom
- Minimalist design

General Specifications

Bathing well at bottom	20" x 42"
Capacity drain to overflow	223 L
Water depth drain to overflow	15"
Overflow opening	2 ½"
Drain to floor clearance	2 ¾"
Colours available	White
Pump/motor (Whirlpool only)	¾ HP / 75 AMP / 120V



Whirlpool Options

Factory Installed Whirlpool Heater	\$ 340
Upgrade to Polished Chrome	\$ 330
Upgrade to Brushed Nickel	\$ 520

Accessories

Universal Tile Flange Kit (see page 54)

MELLA™

66" x 34" x 22"

Soaker

Soaker – Bulk (8)

BO752	\$1,195
BO752-8	\$1,155

Whirlpool – Back Jets

8 side jets, 2 foot jets and 5 spinner back jets

WB752	\$2,820
--------------	----------------

Features & Benefits

- 2" profile
- Allows for top, flush or under mount installation
- Accepts deck mounted faucet
- Sloped lumbar support
- Above floor rough-in
- Patterned bottom
- Minimalist design

General Specifications

Bathing well at bottom	23" x 47"
Capacity drain to overflow	318 L
Water depth drain to overflow	15"
Overflow opening	2 ½"
Drain to floor clearance	2 ¾"
Colours available	White
Pump/motor (Whirlpool only)	¾ HP / 75 AMP / 120V



Accessories

Universal Tile Flange Kit (see page 54)

PUR™

72" x 36" x 22"

Soaker

BO932

\$1,350

Soaker – Bulk (8)

BO932-8

\$1,310

Features & Benefits

- 2" profile
- Allows for top, flush or under mount installation
- Accepts deck mounted faucet
- Sloped lumbar support
- Above floor rough-in
- Patterned bottom

General Specifications

Bathing well at bottom	25" x 55"
Capacity drain to overflow	364 L
Water depth drain to overflow	15"
Overflow opening	2 ½"
Drain to floor clearance	2 ¾"
Colours available	White



Accessories

Universal Tile Flange Kit (see page 54)

PO™ 2

72" x 42" x 22"

Soaker

BO902

\$1,455

Soaker – Bulk (8)

BO902-8

\$1,415

Features & Benefits

- 2" profile
- Allows for top, flush or under mount installation
- Accepts deck mounted faucet
- Dual sloped lumbar support
- Above floor rough-in
- Centre drain
- Patterned bottom

General Specifications

Bathing well at bottom	28" x 41"
Capacity drain to overflow	499 L
Water depth drain to overflow	16 ½"
Overflow opening	2 ½"
Drain to floor clearance	2 ¾"
Colours available	White



SOHO™ 1

60" x 60" x 20"

Soaker	SO606	\$1,135
Soaker – Bulk (10)	SO606-10	\$1,095
Whirlpool	SO606AW	\$2,495
8 side jets		
Whirlpool – Dual Back Jets	SO606BW	\$3,140
8 side jets and 10 spinner back jets		

Whirlpool Options

Factory Installed Whirlpool Heater	\$ 340
Upgrade to Polished Chrome	\$ 235
+ Dual Back Jets Polished Chrome	\$ 185
Upgrade to Brushed Nickel	\$ 395
+ Dual Back Jets Brushed Nickel	\$ 245

Accessories

Universal Tile Flange Kit (see page 54)

Features & Benefits

- Accepts deck mounted faucet
- Above floor rough-in
- Sloped lumbar support
- Patterned bottom
- Fits most standard corner applications

General Specifications

Bathing well at bottom	26" x 45"
Capacity drain to overflow	241 L
Water depth drain to overflow	12"
Overflow opening	2 ½"
Drain to floor clearance	2 ¾"
Colours available	White
Pump/motor (Whirlpool only)	¾ HP / 7.5 AMP / 120V

TUB SHOWERS

The Mirolin® brand is a market leader in the tub shower market with innovative designs in both one piece and multi piece units. They feature generous shelving and spacious bathing wells. Tub Showers are ideal for both new construction and home renovation projects.



See page 59 for further information



LIBERTY™

60" x 33 1/2" x 88" — One-Piece
LEFT OR RIGHT IS DETERMINED BY PLUMBING.

Soaker – Left Drain	TS5L	\$1,820
Soaker – Right Drain	TS5R	\$1,820

Features & Benefits

- Sloped lumbar support
- Convenient dual armrests
- Generous shelving
- Built-in acrylic towel bar
- Available in left/right configuration
- Above floor rough-in
- Patterned bottom

Doors for 60" Tub Shower

Bypass Tub Shower Door	
BDL53PS (Plain, Silver)	\$ 780
BDL53MS (Mystique, Silver)	\$ 850

Accessories

Dome Light, Curtain Rod (see pages 54-55)

General Specifications

Bathing well at bottom	21" x 46"
Capacity drain to overflow	209 L
Water depth drain to overflow	13"
Overflow opening	2 1/2"
Drain to floor clearance	2 3/4"
Colours available	White

**ONE-PIECE****Doors for 60" Tub Shower**

Bypass Tub Shower Door

BDTL54PS (Plain, Silver)

\$ 780

HAMPTON™

60" x 31" x 88" — One-Piece

LEFT OR RIGHT IS DETERMINED BY PLUMBING.

Soaker – Left Drain**Soaker** – Right Drain**TSH51L****\$1,875****TSH51R****\$1,875****Features & Benefits**

- Minimalist design
- Large bathing well with armrests
- Sloped lumbar support
- Generous shelving
- Built-in minimalist colour coordinated grab bar
- Available in left/right configuration
- Above floor rough-in
- Front forward facing flange for ease of installation
- Patterned bottom

General Specifications

Bathing well at bottom	23" x 47"
Capacity drain to overflow	230 L
Water depth drain to overflow	13"
Overflow opening	2 ½"
Drain to floor clearance	3"
Colours available	White

**MULTI-PIECE****Doors for 60" Tub Shower**

Bypass Tub Shower Door

BDTL54PS (Plain, Silver)

\$ 780

TRIBECA™

60" x 32" x 88" — Multi-Piece

LEFT OR RIGHT IS DETERMINED BY PLUMBING.

Soaker – Left Drain**Soaker** – Right Drain**TST53L****\$2,535****TST53R****\$2,535****Features & Benefits**

- Minimalist design
- Large bathing well with armrests
- Sloped lumbar support
- Generous shelving
- Built-in minimalist colour coordinated grab bar
- Available in left/right configuration
- Above floor rough-in
- Front facing forward flange for ease of installation
- Bandless overlap joint with latch system (14 latches)
- Patterned bottom

General Specifications

Bathing well at bottom	23" x 47"
Capacity drain to overflow	230 L
Water depth drain to overflow	13"
Overflow opening	2 ½"
Drain to floor clearance	3"
Colours available	White

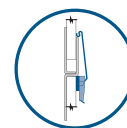
Latch Fit System
for Easy Assembly



ONE-PIECE

Doors for 60" Tub Shower

Bypass Tub Shower Door	
BDL50PS (Plain, Silver)	\$ 780
BDL50MS (Mystique, Silver)	\$ 850

Accessories

Dome Light, Curtain Rod (see pages 54-55)

PARKER™ 20

60" x 32" x 89 ½" — One-Piece
LEFT OR RIGHT IS DETERMINED BY PLUMBING.

Soaker – Left Drain	PT520L	\$1,820
Soaker – Right Drain	PT520R	\$1,820

Features & Benefits

- Sloped lumbar support
- Generous shelving
- Includes colour coordinated "S" shape grab bar
- Available in left/right configuration
- Above floor rough-in
- Patterned bottom

General Specifications

Bathing well at bottom	23 ½" x 44 ½"
Capacity drain to overflow	223 L
Water depth drain to overflow	13 ½"
Overflow opening	2 ½"
Drain to floor clearance	2 ¾"
Colours available	White



MULTI-PIECE

Doors for 60" Tub Shower

Bypass Tub Shower Door	
BDL50PS (Plain, Silver)	\$ 780
BDL50MS (Mystique, Silver)	\$ 850

Accessories

Dome Light, Curtain Rod (see pages 54-55)

PARKER™ 20

60" x 33" x 85 ½" — Multi-Piece
LEFT OR RIGHT IS DETERMINED BY PLUMBING.

Soaker – Left Drain	PT523L	\$2,450
Soaker – Right Drain	PT523R	\$2,450

Features & Benefits

- Sloped lumbar support
- Generous shelving
- Includes colour coordinated "S" shape grab bar
- Snap-Fit® system assembly
- Available in left/right configuration
- Above floor rough-in
- Patterned bottom

General Specifications

Bathing well at bottom	23 ½" x 44 ½"
Capacity drain to overflow	223 L
Water depth drain to overflow	13 ½"
Overflow opening	2 ½"
Drain to floor clearance	2 ¾"
Colours available	White



Snap-Fit® Maintenance
Free Overlap System



Features & Benefits

- Low 16" threshold for easy entry and exit
- Sloped lumbar support
- Generous shelving
- Includes colour coordinated "S" shape grab bar
- Available in left/right configuration
- Above floor rough-in
- Snap-Fit® system assembly on multi piece
- Patterned bottom

Doors for 60" Tub Shower

Bypass Tub Shower Door

BDL49PS (Plain, Silver)	\$ 825
BDL49MS (Mystique, Silver)	\$ 890

Accessories

Dome Light, Curtain Rod (see pages 54-55)

PARKER™ 16

60" x 32" x 89 ½" — One-Piece

LEFT OR RIGHT IS DETERMINED BY PLUMBING.

Soaker – Left Drain

PT516L \$1,820

Soaker – Right Drain

PT516R \$1,820

Free Living Light

Includes right and left side grab bars for safe and easy entry

Soaker – Left Drain

FPL16L \$2,240

Soaker – Right Drain

FPL16R \$2,240

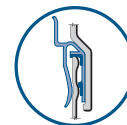

Snap-Fit® Maintenance
Free Overlap System

PARKER™ 16

60" x 33" x 85 ½" — Multi-Piece

LEFT OR RIGHT IS DETERMINED BY PLUMBING.

Soaker – Left Drain

PT513L \$2,450

Soaker – Right Drain

PT513R \$2,450

Free Living Light

Includes right and left side grab bars for safe and easy entry

Soaker – Left Drain

FPL13L \$2,870

Soaker – Right Drain

FPL13R \$2,870

FREE LIVING LIGHT

Offers bather's a right and left side grab bar for safe and easy entry on either side of the tub shower.



Grab bars included:

Two 24"- White vertical grab bars
1 ¼" diameter white coated grab bars
with concealed mounting

General Specifications

Bathing well at bottom	23 ½" x 46 ½"
Capacity drain to overflow	145 L
Water depth drain to overflow	10"
Overflow opening	2 ½"
Drain to floor clearance	2 ¾"
Colours available	White



EMPIRE™

59 ½" x 31" x 85 ½" — Multi-Piece
LEFT OR RIGHT IS DETERMINED BY PLUMBING.



Snap-Fit® Maintenance
Free Overlap System

Soaker – Left Drain

KD53L \$2,450

Soaker – Right Drain

KD53R \$2,450

Features & Benefits

- Sloped lumbar support
- Convenient dual armrests
- Generous shelving
- Built-in acrylic towel bar
- Snap-Fit® system assembly
- Available in left/right configuration
- Above floor rough-in
- Patterned bottom

General Specifications

Bathing well at bottom	21" x 43"
Capacity drain to overflow	209 L
Water depth drain to overflow	13"
Overflow opening	2 ½"
Drain to floor clearance	2 ¾"
Colours available	White

Doors for 60" Tub Shower

Bypass Tub Shower Door

BDL52PS (Plain, Silver) \$ 780

BDL52MS (Mystique, Silver) \$ 850

Accessories

Dome Light, Curtain Rod (see pages 54-55)

SUTTON™

60" x 33" x 80" — Two-Piece
LEFT OR RIGHT IS DETERMINED BY PLUMBING.

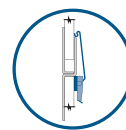

Latch Fit System
for Easy Assembly

Soaker – Left Drain

TSS52L \$1,770

Soaker – Right Drain

TSS52R \$1,770

Features & Benefits

- Minimalist design
- Large bathing well with armrests
- Sloped lumbar support
- Generous shelving
- Built-in minimalist colour coordinated grab bar
- Available In left/right configuration
- Above floor rough-in
- Front forward facing flange for ease of installation
- Bandless overlap joint with latch system (7 latches)
- Patterned bottom

General Specifications

Bathing well at bottom	23" x 47"
Capacity drain to overflow	230 L
Water depth drain to overflow	13"
Overflow opening	2 ½"
Drain to floor clearance	3"
Colours available	White



Doors for 60" Tub Shower

Bypass Tub Shower Door

BDTL54PS (Plain, Silver) \$ 780



ONE-PIECE

BELAIRE™

60" x 32 ½" x 78" — One-Piece
LEFT OR RIGHT IS DETERMINED BY PLUMBING.

Soaker – Left Drain
Soaker – Right Drain

BA5L **\$1,490**
BA5R **\$1,490**

Features & Benefits

- Sloped lumbar support
- Convenient dual armrests
- Generous shelving
- Built-in acrylic towel bar
- Available in left/right configuration
- Above floor rough-in
- Patterned bottom

Doors for 60" Tub Shower

Bypass Tub Shower Door	
BDL55PS (Plain, Silver)	\$ 780
BDL55MS (Mystique, Silver)	\$ 850

Accessories

Curtain Rod (see page 55)

General Specifications

Bathing well at bottom	22" x 45"
Capacity drain to overflow	219 L
Water depth drain to overflow	13 ¼"
Overflow opening	2 ½"
Drain to floor clearance	2 ¾"
Colours available	White

SHOWERS

Mirolin® showers offer you a full line of acrylic shower stalls.
Available in seamless one piece and easy to install multi piece units.
These showers are ideal for any bathroom configuration.



Features & Benefits

- Low 4" threshold for easy entry and exit
- Generous shelving
- Includes colour coordinated "S" shape grab bar
- Available with or without seat option
- 16½" Comfort height seat
- Available in left/right configuration
- Includes FD2 chrome floor drain
- Snap-Fit® system assembly on multi piece
- Patterned bottom

Doors

Bypass Shower Door

BDL54PS (Plain, Silver)	\$ 780
BDL54MS (Mystique, Silver)	\$ 850

Accessories

Dome Light, Curtain Rod (see pages 54-55)

General Specifications

Drain opening	3 ¼"
Drain to floor clearance	1 ¼"
Colours available	White

MADISON™ 5

60" x 33 ¼" x 88" — One-Piece

LEFT OR RIGHT IS DETERMINED BY PLUMBING, OPPOSITE OF SEAT.

Shower Stall with Seat – Left Drain	SH5LS	\$1,975
Shower Stall with Seat – Right Drain	SH5RS	\$1,975
Shower Stall without Seat – Left Drain	SH5L	\$1,975
Shower Stall without Seat – Right Drain	SH5R	\$1,975

Free Living Standard

Includes right and left side grab bars for safe and easy entry

Shower Stall with Seat – Left Drain	FS5LS	\$2,510
Shower Stall with Seat – Right Drain	FS5RS	\$2,510
Shower Stall without Seat – Left Drain	FS5L	\$2,510
Shower Stall without Seat – Right Drain	FS5R	\$2,510



Snap-Fit® Maintenance
Free Overlap System

MADISON™ 5

60" x 34 ¼" x 84 ½" — Multi-Piece

LEFT OR RIGHT IS DETERMINED BY PLUMBING, OPPOSITE OF SEAT.

Shower Stall with Seat – Left Drain	SH53LS	\$2,595
Shower Stall with Seat – Right Drain	SH53RS	\$2,595
Shower Stall without Seat – Left Drain	SH53L	\$2,595
Shower Stall without Seat – Right Drain	SH53R	\$2,595

Free Living Standard

Includes right and left side grab bars for safe and easy entry

Shower Stall with Seat – Left Drain	FS53LS	\$3,130
Shower Stall with Seat – Right Drain	FS53RS	\$3,130
Shower Stall without Seat – Left Drain	FS53L	\$3,130
Shower Stall without Seat – Right Drain	FS53R	\$3,130

FREE LIVING STANDARD

Offers bather's the safety and comfort of easy grab bar entry, and the added support of an L-Shape bar for easy movement while you shower.



Grab bars included:

One 24" - White vertical grab bar
One 24" x 16" - White L-shaped grab bar
1 ¼" diameter white coated grab bars
with concealed mounting



ONE-PIECE

Doors

Bypass Shower Door	
BDL4IPS (Plain, Silver)	\$ 755
BDL4IMS (Mystique, Silver)	\$ 820

Accessories

Dome Light, Curtain Rod (see pages 54-55)

MADISON™ 4

50" x 33 1/2" x 88" — One-Piece
LEFT OR RIGHT IS DETERMINED BY PLUMBING, OPPOSITE OF SEAT.

Shower Stall with Seat – Left Plumbing	SH4LS	\$1,795
Shower Stall with Seat – Right Plumbing	SH4RS	\$1,795
Shower Stall without Seat – Left Plumbing	SH4L	\$1,795
Shower Stall without Seat – Right Plumbing	SH4R	\$1,795

Features & Benefits

- Low 4" threshold for easy entry and exit
- Generous shelving
- Includes colour coordinated "S" shape grab bar
- Available with or without seat option
- 18" Comfort height seat
- Centre drain
- Includes FD2 chrome floor drain
- Patterned bottom

General Specifications

Drain opening	3 1/4"
Drain to floor clearance	5/8"
Colours available	White



MULTI-PIECE

Doors

Bypass Shower Door	
BDL4IPS (Plain, Silver)	\$ 755
BDL4IMS (Mystique, Silver)	\$ 820

Accessories

Dome Light, Curtain Rod (see pages 54-55)

MADISON™ 4

50" x 34 1/2" x 84 1/2" — Multi-Piece
LEFT OR RIGHT IS DETERMINED BY PLUMBING, OPPOSITE OF SEAT.

Shower Stall with Seat – Left Plumbing	SH43LS	\$2,340
Shower Stall with Seat – Right Plumbing	SH43RS	\$2,340
Shower Stall without Seat – Left Plumbing	SH43L	\$2,340
Shower Stall without Seat – Right Plumbing	SH43R	\$2,340

Features & Benefits

- Low 4" threshold for easy entry and exit
- Generous shelving
- Includes colour coordinated "S" shape grab bar
- Available with or without seat option
- 18" Comfort height seat
- Centre drain
- Includes FD2 chrome floor drain
- Snap-Fit® system assembly on multi piece
- Patterned bottom

General Specifications

Drain opening	3 1/4"
Drain to floor clearance	5/8"
Colours available	White



Snap-Fit® Maintenance Free Overlap System

**ONE-PIECE****Doors****Swing Shower Door**

SDM30PS (Plain, Silver) \$ 505

SDM30RS (Raindrop, Silver) \$ 505

Accessories

Dome Light, Curtain Rod (see pages 54-55)

MADISON™ 3

38" x 33 1/4" x 88" — One-Piece

LEFT OR RIGHT IS DETERMINED BY PLUMBING.

Shower Stall – Left Plumbing**SH3L \$1,605****Shower Stall – Right Plumbing****SH3R \$1,605****Features & Benefits**

- Low 4" threshold for easy entry and exit
- Generous shelving
- Includes colour coordinated "S" shape grab bar
- Convenient footrests
- Centre drain
- Includes FD2 chrome floor drain
- Patterned bottom

General Specifications

Drain opening	3 1/4"
Drain to floor clearance	1 1/4"
Colours available	White

**MULTI-PIECE****Doors****Swing Shower Door**

SDM30PS (Plain, Silver) \$ 505

SDM30RS (Raindrop, Silver) \$ 505

Accessories

Dome Light, Curtain Rod (see pages 54-55)

MADISON™ 3

38" x 34 1/4" x 84 1/2" — Multi-Piece

LEFT OR RIGHT IS DETERMINED BY PLUMBING.

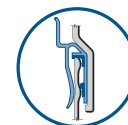
Shower Stall – Left Plumbing**SH33L \$2,095****Shower Stall – Right Plumbing****SH33R \$2,095**Snap-Fit® Maintenance
Free Overlap System**Features & Benefits**

- Low 4" threshold for easy entry and exit
- Generous shelving
- Includes colour coordinated "S" shape grab bar
- Convenient footrests
- Centre drain
- Includes FD2 chrome floor drain
- Snap-Fit® system assembly
- Patterned bottom

General Specifications

Drain opening	3 1/4"
Drain to floor clearance	1 1/4"
Colours available	White



Doors

Bypass Shower Door	
BDL56PS (Plain, Silver)	\$ 780
BDL56MS (Mystique, Silver)	\$ 850

Accessories

Curtain Rod (see page 55)

MELROSE™ 5

60" x 36" x 80" — One-Piece
LEFT OR RIGHT IS DETERMINED BY PLUMBING, OPPOSITE OF SEAT.

Shower Stall with Seat – Left Drain	MEL5LS	\$1,635
Shower Stall with Seat – Right Drain	MEL5RS	\$1,635

Features & Benefits

- Low 4" threshold for easy entry and exit
- Generous shelving
- 18" Comfort height seat
- Available in left or right end drain
- Includes FD2 chrome floor drain
- Built-in acrylic towel bar
- Patterned bottom

General Specifications

Drain opening	3 ¼"
Drain to floor clearance	½"
Colours available	White



Doors

Bypass Shower Door	
BDL56PS (Plain, Silver)	\$ 780
BDL56MS (Mystique, Silver)	\$ 850

Accessories

Curtain Rod (see page 55)

MELROSE™ 5

60" x 36" x 80" — One-Piece
LEFT OR RIGHT IS DETERMINED BY PLUMBING, OPPOSITE OF SEAT.

Shower Stall with Seat – Left Plumbing	MEL5CLS	\$1,635
Shower Stall with Seat – Right Plumbing	MEL5CRS	\$1,635
Shower Stall without Seat	MEL5C	\$1,635

Features & Benefits

- Low 4" threshold for easy entry and exit
- Generous shelving
- Available with or without seat option
- 18" Comfort height seat
- Centre drain
- Includes FD2 chrome floor drain
- Built-in acrylic towel bar
- Patterned bottom

General Specifications

Drain opening	3 ¼"
Drain to floor clearance	½"
Colours available	White

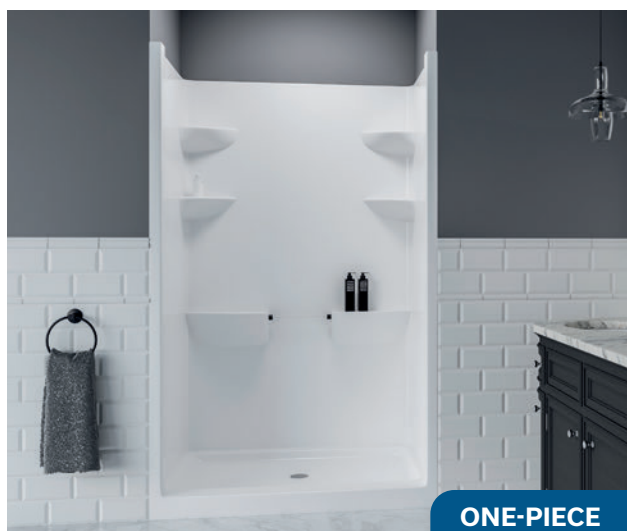
**ONE-PIECE****Doors**

Bypass Shower Door

BDL44PS (Plain, Silver)

\$ 755

BDL44MS (Mystique, Silver)

\$ 820

Accessories

Curtain Rod (see page 55)

MELROSE™ 4

48" x 37" x 80" — One-Piece

LEFT OR RIGHT IS DETERMINED BY PLUMBING, OPPOSITE OF SEAT.

Shower Stall with Seat – Left Plumbing**MEL4LS \$1,480****Shower Stall with Seat – Right Plumbing****MEL4RS \$1,480****Shower Stall without Seat****MEL4 \$1,480****Features & Benefits**

- Low 4" threshold for easy entry and exit
- Generous shelving
- Available with or without seat
- 18" Comfort height seat
- Centre drain
- Includes FD2 chrome floor drain
- Built-in acrylic towel bar
- Patterned bottom

General Specifications

Drain opening	3 ¼"
Drain to floor clearance	1"
Colours available	White

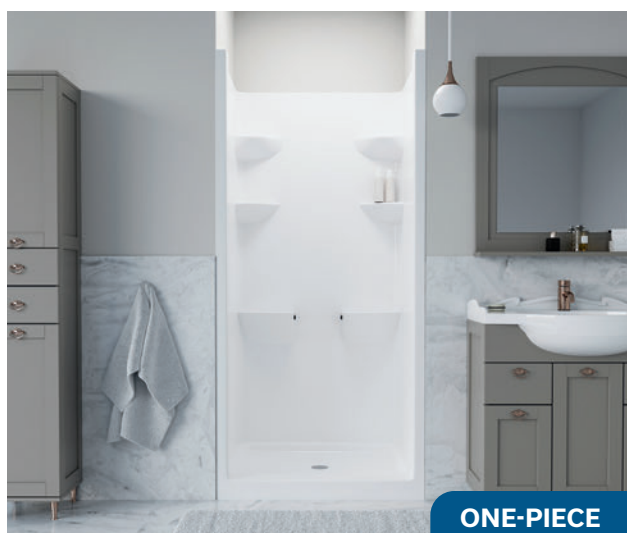
**ONE-PIECE****Doors**

Swing Shower Door

SD31PS (Plain, Silver)

\$ 515

Accessories

Curtain Rod (see page 55)

MELROSE™ 3

36" x 36" x 80" — One-Piece

LEFT OR RIGHT IS DETERMINED BY PLUMBING.

Shower Stall**MEL3 \$1,320****Features & Benefits**

- Low 4" threshold for easy entry and exit
- Generous shelving
- Centre drain
- Includes FD2 chrome floor drain
- Built-in acrylic towel bar
- Patterned bottom

General Specifications

Drain opening	3 ¼"
Drain to floor clearance	1"
Colours available	White



Doors

Neo-Angle Shower Door	
CD38NAPS (Plain, Silver)	\$ 880
CD38NARS (Raindrop, Silver)	\$ 880

SORRENTO™ 38

38 ¾" x 38 ¾" x 76 ¼" — Neo-Angle One-Piece

Shower Stall	SC38NA	\$1,235
Shower Stall - Bulk (2)	SC38NA-2	\$1,195

Features & Benefits

- Low 3" threshold for easy entry and exit
- Generous shelving
- Convenient footrest
- Includes FD2 chrome floor drain
- Patterned bottom

General Specifications

Drain opening	3 ¼"
Drain to floor clearance	¾"
Colours available	White



Doors

Round Front Pivot Shower Door	
CD38RFPS (Plain, Silver)	\$ 900
CD38RFRS (Raindrop, Silver)	\$ 900
Round Front Sliding Shower Door	
38RFDPS (Plain, Silver)	\$ 900

SORRENTO™ 38

38 ¼" x 38 ¼" x 76 ¼" — Round Front One-Piece

Shower Stall	SC38RF	\$1,315
Shower Stall - Bulk (2)	SC38RF-2	\$1,270

Features & Benefits

- Low 3" threshold for easy entry and exit
- Generous shelving
- Convenient footrest
- Includes FD2 chrome floor drain
- Patterned bottom

General Specifications

Drain opening	3 ¼"
Drain to floor clearance	¾"
Colours available	White

SHOWER DOORS

Compliment your bathtub, shower, or shower base with a Mirolin® shower door. These doors are available in a variety of sizes and styles and are sure to meet your design application needs.

GLASS PATTERNS



Plain Glass
with Silver Trim **(PS)**



Mystique Glass
with Silver Trim **(MS)**

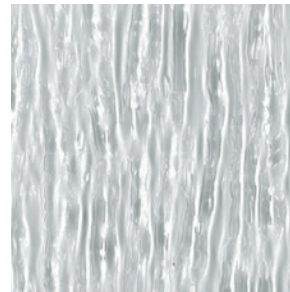

Raindrop Glass
with Silver Trim **(RS)**



BYPASS SERIES

Bypass Shower Door (BDL/BDSL Models)

Bypass Bathtub Door (BDTL Models)

Features & Benefits

- Ready to assemble bypass tub & shower door systems
- 8mm glass
- Low friction rolling system provides effortless function
- Reversible left/right configuration
- Convenient towel bars
- Available in clear and obscure mystique glass patterns

Bypass Series – Tub Shower Doors

Opening	Height	Finish	Code	Fits	List
53" – 54"	60"	Plain, Silver	BDL49PS	Parker™ 16 Tub Shower	\$ 825
53" – 54"	60"	Mystique, Silver	BDL49MS	Parker™ 16 Tub Shower	\$ 890
51 ½" – 52 ½"	56"	Plain, Silver	BDL52PS	Empire™ Tub Shower	\$ 780
51 ½" – 52 ½"	56"	Mystique, Silver	BDL52MS	Empire™ Tub Shower	\$ 850
51 ¾" – 52 ¾"	56"	Plain, Silver	BDL53PS	Liberty™ Tub Shower	\$ 780
51 ¾" – 52 ¾"	56"	Mystique, Silver	BDL53MS	Liberty™ Tub Shower	\$ 850
55" – 56"	56"	Plain, Silver	BDL55PS	Belaire™ Tub Shower – One Piece	\$ 780
55" – 56"	56"	Mystique, Silver	BDL55MS	Belaire™ Tub Shower – One Piece	\$ 850
53" – 54"	56"	Plain, Silver	BDL50PS	Parker™ 20 Tub Shower	\$ 780
53" – 54"	56"	Mystique, Silver	BDL50MS	Parker™ 20 Tub Shower	\$ 850
54 ¼" – 55 ¼"	56"	Plain, Silver	BDTL54PS	Hampton™ Sutton™ Tribeca™ Tub Shower	\$ 780

Bypass Series – Bathtub Shower Doors

Opening	Height	Finish	Code	Fits	List
59" – 60"	56"	Plain, Silver	BDTL60PS	60" Standard Bath	\$ 825
59" – 60"	56"	Mystique, Silver	BDTL60MS	60" Standard Bath	\$ 890

Bypass Series – Shower Doors

Opening	Height	Finish	Code	Fits	List
42 ¾" – 43 ¾"	73"	Plain, Silver	BDL41PS	Madison™ 4 Shower Stall	\$ 755
42 ¾" – 43 ¾"	73"	Mystique, Silver	BDL41MS	Madison™ 4 Shower Stall	\$ 820
41 ¾" – 42 ¾"	73"	Plain, Silver	BDL44PS	Melrose™ 4 Shower Stall	\$ 755
41 ¾" – 42 ¾"	73"	Mystique, Silver	BDL44MS	Melrose™ 4 Shower Stall	\$ 820
47" – 48"	73"	Plain, Silver	BDL48PS	Strada™ 48" Base, Ellis™ 48" Base	\$ 755
47" – 48"	73"	Mystique, Silver	BDL48MS	Strada™ 48" Base, Ellis™ 48" Base	\$ 820
52 ⅝" – 53 ⅝"	73"	Plain, Silver	BDL54PS	Madison™ 5 Shower Stall	\$ 780
52 ⅝" – 53 ⅝"	73"	Mystique, Silver	BDL54MS	Madison™ 5 Shower Stall	\$ 850
54 ¼" – 55 ¼"	73"	Plain, Silver	BDL56PS	Melrose™ 5 Shower Stall, Weston™ 5	\$ 780
54 ¼" – 55 ¼"	73"	Mystique, Silver	BDL56MS	Melrose™ 5 Shower Stall, Weston™ 5	\$ 850
59" – 60"	73"	Plain, Silver	BDSL60PS	Strada™ 60", Ellis™ 60" Base/Pkg	\$ 825
59" – 60"	73"	Mystique, Silver	BDSL60MS	Strada™ 60", Ellis™ 60" Base/Pkg	\$ 890



SWING DOOR SERIES

Swing Shower Door (SD, SDM Models)
Framed Swing Shower Door (MSD Models)

Features & Benefits

- Ready to assemble swing door systems
- Available in a variety of sizes
- SD 6mm Clear glass – Frameless
- SDM 6mm Clear or Raindrop glass pattern – Frameless
- MSD 4mm Clear glass – Framed

Swing Door Series – Shower Doors

Opening	Height	Finish	Code	Fits	List
25 ½" – 26 ½"	69"	Plain, Silver	SD26PS	Tile Applications	\$ 465
30 ½" – 31 ½"	69"	Plain, Silver	SDM30PS	Madison™ 3	\$ 505
30 ½" – 31 ½"	69"	Raindrop, Silver	SDM30RS	Madison™ 3	\$ 505
30 ½" – 31 ½"	69"	Plain, Silver	SD31PS	Melrose™ 3	\$ 515
33 ½" – 34 ½"	69"	Plain, Silver	SD34PS	Strada™ 36" Base & Tile Applications	\$ 515

Swing Door Series – Framed Shower Doors

Opening	Height	Finish	Code	Fits	List
23 ½" – 24 ½"	65"	Plain, Silver	MSD24PS	Tile Applications	\$ 325
24 ½" – 25 ½"	65"	Plain, Silver	MSD25PS	Tile Applications	\$ 325



RETROFIT SHOWER SERIES

Features & Benefits

- 6mm glass on 38NAFS
- Collapsible design increases opening for greater accessibility

Retrofit Shower Series

Opening	Height	Finish	Code	Fits	List
n/a	73"	Frosted, Silver	38NAFS	NAS38, V23838	\$ 900

ROLL TOP SERIES

Roll Top Door (RT Models)

Features & Benefits

- Ready to assemble roll top door systems
- 8mm clear glass
- 8mm glass return panel available for corner applications
- Reversible left/right configuration
- Low friction rolling system provides effortless function
- Minimalist design



Roll Top Series – Bathtub Doors

Opening	Height	Finish	Code	Fits	List
58 ½" – 59 ½"	56"	Plain, Silver	RT60BTPS	60" Standard Bath	\$ 1,110

Roll Top Series – Shower Doors

Opening	Height	Finish	Code	Fits	List
46 ½" – 47 ½"	74 ½"	Plain, Silver	RT48FPS	Strada™ 48" Base, Ellis™ 48" Base	\$ 1,035
58 ½" – 59 ½"	74 ½"	Plain, Silver	RT60FPS	Strada™ 60" Base, Ellis™ 60" Base	\$ 1,110

Roll Top Series – Return Panel

Opening	Height	Finish	Code	Fits	List
34 ¾" ± ¼"	74 ½"	Plain, Silver	RT36SPS	Strada™ Bases & Tile Applications	\$ 340



* Round front pivot shown

CORNER SHOWER SERIES

Neo-Angle Shower Doors (NA Models)
Round Front Shower Doors (RF Models)

Features & Benefits

- Ready to assemble corner door systems
- 6mm glass
- Frameless design to suit any bath décor
- Reversible left/right configuration
- Available in a variety of sizes

Corner Shower Series – Neo-Angle Pivot Shower Doors

Opening	Height	Finish	Code	Fits	List
n/a	72"	Plain, Silver	CD38NAPS	38" Sorrento™ Neo-Angle	\$ 880
n/a	72"	Raindrop, Silver	CD38NARS	38" Sorrento™ Neo-Angle	\$ 880
n/a	72"	Plain, Silver	42NADPS	42" Sorrento™ Neo-Angle	\$ 1,130

Corner Shower Series – Round Front Pivot Shower Doors

Opening	Height	Finish	Code	Fits	List
n/a	72"	Plain, Silver	CD38RFPS	38" Sorrento™ Round Front	\$ 900
n/a	72"	Raindrop, Silver	CD38RFRS	38" Sorrento™ Round Front	\$ 900
n/a	72"	Plain, Silver	42RFDPs	42" Sorrento™ Round Front	\$ 1,155

Corner Shower Series – Round Front Sliding Shower Doors

Opening	Height	Finish	Code	Fits	List
n/a	73"	Plain, Silver	38RFDPs	38" Sorrento™ Round Front	\$ 900

SHOWER BASES

Mirolin® shower bases offer a complete line of functional shower bases and receptor bases to meet your bathroom designs. Each acrylic product is manufactured with superior quality and durability making each surface scratch resistant and easy to clean.



See page 59 for further information

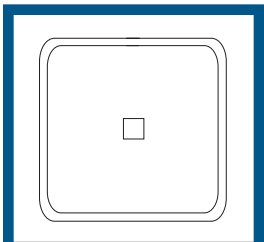

Doors
Swing Door
SD34PS (Plain, Silver)

\$ 515

STRADA™

36" x 36" x 3" — 3-Sided Alcove Flange
LEFT OR RIGHT IS DETERMINED BY PLUMBING.

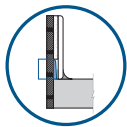

Integrated Tile Flange

Acrylic Shower Base
Centre drain

SQD3636A \$610

- Features & Benefits**
- Low 3" threshold for easy entry and exit
 - Includes FD3 chrome floor drain
 - Integral tile flange
 - Patterned bottom

General Specifications

Colours available	White
-------------------	-------

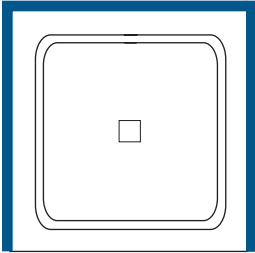

STRADA™

42" x 42" x 3" — 3-Sided Alcove Flange
LEFT OR RIGHT IS DETERMINED BY PLUMBING.

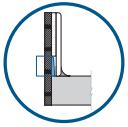

Integrated
Tile Flange

Acrylic Shower Base
Centre drain

SQD4242A \$640

Features & Benefits

- Low 3" threshold for easy entry and exit
- Includes FD3 chrome floor drain
- Integral tile flange
- Patterned bottom

General Specifications

Colours available	White
-------------------	-------

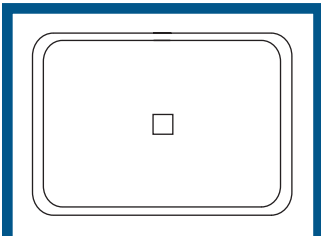

STRADA™

48" x 36" x 3" — 3-Sided Alcove Flange
LEFT OR RIGHT IS DETERMINED BY PLUMBING.

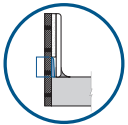

Integrated
Tile Flange

Acrylic Shower Base
Centre drain

SQC4836A \$680

Features & Benefits

- Low 3" threshold for easy entry and exit
- Includes FD4 chrome floor drain
- Integral tile flange
- Patterned bottom

Doors

Roll Top Shower Door
RT48FPS (Plain, Silver) \$ 1,035

Bypass Shower Door
BDL48PS (Plain, Silver) \$ 755
BDL48MS (Mystique, Silver) \$ 825

General Specifications

Colours available	White
-------------------	-------

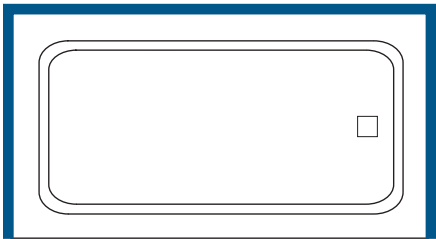

Doors	
Roll Top Shower Door	
RT60FPS (Plain, Silver)	\$ 1,110
Bypass Shower Door	
BDSL60PS (Plain, Silver)	\$ 825
BDSL60MS (Mystique, Silver)	\$ 890

STRADA™

60" x 30" x 3" — 3-Sided Alcove Flange
LEFT OR RIGHT IS DETERMINED BY PLUMBING.

Acrylic Shower Base – Left Drain	SQC6030LA	\$760
Acrylic Shower Base – Right Drain	SQC6030RA	\$760

60" x 32" x 3" — 3-Sided Alcove Flange
LEFT OR RIGHT IS DETERMINED BY PLUMBING.

Acrylic Shower Base – Left Drain	SQC6032LA	\$775
Acrylic Shower Base – Right Drain	SQC6032RA	\$775

- Features & Benefits**
- Low 3" threshold for easy entry and exit
 - Includes FD4 chrome floor drain
 - Integral tile flange
 - Patterned bottom

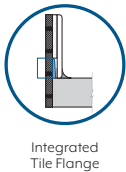

General Specifications

Colours available	White
-------------------	-------

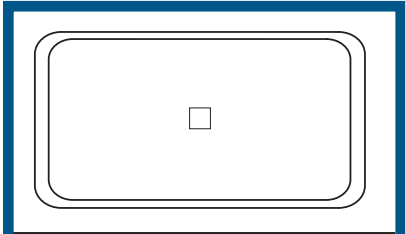

Doors	
Roll Top Shower Door	
RT60FPS (Plain, Silver)	\$ 1,110
Bypass Shower Door	
BDSL60PS (Plain, Silver)	\$ 825
BDSL60MS (Mystique, Silver)	\$ 890

STRADA™

60" x 36" x 3" — 3-Sided Alcove Flange

Acrylic Shower Base	SQC6036A	\$805
Centre drain		

- Features & Benefits**
- Low 3" threshold for easy entry and exit
 - Includes FD4 chrome floor drain
 - Integral tile flange
 - Patterned bottom

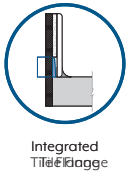

General Specifications

Colours available	White
-------------------	-------

**Doors****Neo-Angle Shower Door**

CD38NAPS (Plain, Silver) \$ 880

CD38NARS (Raindrop, Silver) \$ 880

SORRENTO™

38" x 38" x 3"

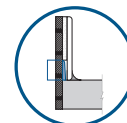
Neo-Angle BaseIntegrated
Tile Flange**SB38NA****\$680****Features & Benefits**

- Low 3" threshold for easy entry and exit
- Integral tile flange
- Patterned bottom
- Drain not included

General Specifications

Colours available

White

**Doors****Round Front Pivot Shower Door**

CD38RFPS (Plain, Silver) \$ 900

CD38RFRS (Raindrop, Silver) \$ 900

Round Front Sliding Shower Door

38RFDPS (Plain, Silver) \$ 900

SORRENTO™

37 1/2" x 37 1/2" x 3"

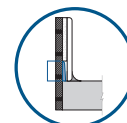
Round Front BaseIntegrated
Tile Flange**SB38RF****\$710****Features & Benefits**

- Low 3" threshold for easy entry and exit
- Integral tile flange
- Patterned bottom
- Drain not included

General Specifications

Colours available

White

ACCESSIBLE

Mirolin® accessible products offer a full line of one piece accessible tub and shower products. Our Access line offer low thresholds for easy entry and exit and meet a variety of industry certification standards. Grab bar configurations on both showers and tub showers include factory installed shower curtain rods.



See page 59 for further information



Accessories
Dome Light (see page 54)

ACCESS™ 66



66" x 37 1/4" x 88" — **CSA® B651 Compliant**
LEFT OR RIGHT IS DETERMINED BY PLUMBING, OPPOSITE OF SEAT.

Shower Stall with Fold-up Seat – Left Plumbing **ARS66L** **\$4,335**
Shower Stall with Fold-up Seat – Right Plumbing **ARS66R** **\$4,335**

Features & Benefits

- 1 1/2" threshold for easy entry and exit
- Includes FD2 chrome floor drain
- Stainless steel shower curtain rod installed
- Patterned bottom

Grab Bars Included

- 1 1/4" diameter peened stainless steel grab bars with concealed mounting
- 40"- vertical straight grab bar
 - 40"- horizontal straight grab bar
 - 30"- vertical straight grab bar
 - 24"- horizontal straight grab bar

General Specifications

Drain opening	3 1/4"
Drain to floor clearance	1/4"
Colours available	White



Accessories

Dome Light (see page 54)

ACCESS™ 66



66" x 37 1/4" x 88" — **OBC Compliant**

LEFT OR RIGHT IS DETERMINED BY PLUMBING, OPPOSITE OF SEAT.

Shower Stall with Fold-up Seat – Left Plumbing **AROS66L** **\$3,865**

Shower Stall with Fold-up Seat – Right Plumbing **AROS66R** **\$3,865**

Features & Benefits

- 1 1/2" threshold for easy entry and exit
- Includes FD2 chrome floor drain
- Stainless steel shower curtain rod installed
- Patterned bottom

Grab Bar Included

1 1/2" diameter peened stainless steel grab bars with concealed mounting

- 36" x 36" L-Shape grab bar

General Specifications

Drain opening	3 1/4"
Drain to floor clearance	1/4"
Colours available	White



Accessories

Dome Light (see page 54)

RIVERDALE™

60" x 32" x 89 1/2"

LEFT OR RIGHT IS DETERMINED BY PLUMBING.

Soaker – Left Drain

RBF516L **\$2,560**

Soaker – Right Drain

RBF516R **\$2,560**

Features & Benefits

- Low 16" threshold for easy entry and exit
- Includes 48" stainless steel vertical grab bar on drain side wall and 48" horizontal grab bar on back wall
- Patterned bottom

Grab Bars Included

1 1/4" diameter peened stainless steel grab bars with concealed mounting

- 48" horizontal grab bar on the back wall
- 48" vertical grab bar on the drain side wall

General Specifications

Bathing well at bottom	23 1/2" x 46 1/2"
Capacity drain to overflow	145 L
Water depth drain to overflow	10"
Overflow opening	2 1/2"
Drain to floor clearance	2 3/4"
Colours available	White



Features & Benefits

- Low 16" threshold for easy entry and exit
- Sloped lumbar support
- Generous shelving
- Includes colour coordinated "S" shape grab bar
- Available in left/right configuration
- Above floor rough-in
- Snap-Fit® system assembly on multi piece
- Patterned bottom

Doors for 60" Tub Shower

Bypass Tub Shower Door	
BDL49PS (Plain, Silver)	\$ 825
BDL49MS (Mystique, Silver)	\$ 890

Accessories

Dome Light, Curtain Rod (see pages 54-55)

PARKER™ 16

60" x 32" x 89 ½" — One-Piece
LEFT OR RIGHT IS DETERMINED BY PLUMBING.

Free Living Light

Includes right and left side grab bars for safe and easy entry

Soaker – Left Drain	FPL16L	\$2,240
Soaker – Right Drain	FPL16R	\$2,240

PARKER™ 16

60" x 33" x 85 ½" — Multi-Piece
LEFT OR RIGHT IS DETERMINED BY PLUMBING.



Snap-Fit® Maintenance
Free Overlap System

Free Living Light

Includes right and left side grab bars for safe and easy entry

Soaker – Left Drain	FPL13L	\$2,870
Soaker – Right Drain	FPL13R	\$2,870

FREE LIVING LIGHT

Offers bather's a right and left side grab bar for safe and easy entry on either side of the tub shower.



Grab bars included:
Two 24"- White vertical grab bars
1 ¼" diameter white coated grab bars
with concealed mounting

General Specifications

Bathing well at bottom	23 ½" x 46 ½"
Capacity drain to overflow	145 L
Water depth drain to overflow	10"
Overflow opening	2 ½"
Drain to floor clearance	2 ¾"
Colours available	White



Features & Benefits

- Low 4" threshold for easy entry and exit
- Generous shelving
- Includes colour coordinated "S" shape grab bar
- Available with or without seat option
- 16½" Comfort height seat
- Available in left/right configuration
- Includes FD2 chrome floor drain
- Snap-Fit® system assembly on multi piece
- Patterned bottom

Doors

Bypass Shower Door

BDL54PS (Plain, Silver) \$ 780

BDL54MS (Mystique, Silver) \$ 850

Accessories

Dome Light, Curtain Rod (see pages 54-55)

MADISON™ 5

60" x 33 ¼" x 88" — One-Piece

LEFT OR RIGHT IS DETERMINED BY PLUMBING, OPPOSITE OF SEAT.

Free Living Standard

Includes right and left side grab bars for safe and easy entry

Shower Stall with Seat – Left Drain FS5LS \$2,510

Shower Stall with Seat – Right Drain FS5RS \$2,510

Shower Stall without Seat – Left Drain FS5L \$2,510

Shower Stall without Seat – Right Drain FS5R \$2,510

MADISON™ 5

60" x 34 ¼" x 84 ½" — Multi-Piece

LEFT OR RIGHT IS DETERMINED BY PLUMBING, OPPOSITE OF SEAT.

Free Living Standard

Includes right and left side grab bars for safe and easy entry

Shower Stall with Seat – Left Drain FS53LS \$3,130

Shower Stall with Seat – Right Drain FS53RS \$3,130

Shower Stall without Seat – Left Drain FS53L \$3,130

Shower Stall without Seat – Right Drain FS53R \$3,130



Snap-Fit® Maintenance
Free Overlap System

FREE LIVING STANDARD

Offers bather's the safety and comfort of easy grab bar entry, and the added support of an L-Shape bar for easy movement while you shower.



Grab bars included:

One 24" - White vertical grab bar

One 24" x 16" - White L-shaped grab bar

1 ¼" diameter white coated grab bars with concealed mounting

General Specifications

Drain opening	3 ¼"
Drain to floor clearance	1 ¼"
Colours available	White



Brushed Nickel Drain & Overflow Covers

Drain & Overflow Covers **BNDOC** **\$79**

Features & Benefits

- Classic, professional finish to your bath
- Durable and non-corrosive



Dome Light

White Dome Light **DL4WH** **\$120**
Chrome Dome Light **DL4PC** **\$120**

Features & Benefits

- For use in wet locations



Universal Tile Flange Kit

Tile Flange Kit **KTLEV** **\$95**

Features & Benefits

- Adjusts to all bath tubs
- 3 piece Kit: 1 x 73", 1 x 61", 1 x 45"



Acrylic Repair Kit

Acrylic Repair Kit **MARI** **\$90**

Features & Benefits

- Perfect colour match for white Mirolin® Baths
- Great for minor repairs & scratches



Heavy Gauge Curved Bar Curtain Rod

Stainless Steel	CCR55SS	\$125
White	CCR55W	\$160

Fits the Following Products:

TUB SHOWER

Belaire - BA5	Parker 16 - PT516, PT513
Empire - KD53	Parker 20 - PT520, PT523
Liberty - TS5	

SHOWERSTALL

Melrose - MEL5	Madison 5 - SH5, SH53
----------------	-----------------------



Heavy Gauge Straight Bar Curtain Rod

Stainless Steel	CR55SS	\$99
White	CR55W	\$135

Fits the Following Products:

TUB SHOWER

Belaire - BA5	Parker 16 - PT516, PT513
Empire - KD53	Parker 20 - PT520, PT523
Liberty - TS5	

SHOWERSTALL

Madison 5 - SH5, SH53	Madison 4 - SH4, SH43	Madison 3 - SH3, SH33
Melrose 5 - MEL5	Melrose 4 - MEL4	Melrose 3 - MEL3



FD2

FD3

FD4

Floor Drain

Round Chrome Drain	FD2	\$26
Round Chrome Flame Retardant Drain	FD2-X	\$40
Square Chrome Drain	FD3	\$26
Square Chrome Flame Retardant Drain	FD3-X	\$40
Square Chrome Drain	FD4	\$26

Features & Benefits

- Durable and non-corrosive

Fits the Following Products:

FD2 ROUND DRAIN

Access - ARS, AROS	Madison - SH, FS5	Melrose - MEL
Sorrento - SC38	Sorrento Bases - SB38	

FD3 SQUARE DRAIN

Strada Bases - SQD

FD4 SQUARE DRAIN

Strada Bases - SQC

FD2-X ROUND FLAME RETARDANT DRAIN

Access - ARS, AROS	Madison - SH, FS5	Melrose - MEL
Sorrento - SC38	Sorrento Bases - SB38	

FD3-X SQUARE FLAME RETARDANT DRAIN

Strada Bases - SQD

FREE LIVING SERIES



Add functionality and bath safety to Mirolin® tub shower and shower products by choosing a free living option.

FREE LIVING LIGHT

Offers bather's a right and left side grab bar for safe and easy entry on either side of the tub shower.

Grab bars included:

Two 24"- White vertical grab bars
1¼" diameter white coated grab bars
with concealed mounting

Available on Parker™ 16 models



FREE LIVING STANDARD

Offers bather's the safety and comfort of easy grab bar entry, and the added support of an L-Shape bar for easy movement while you shower.

Grab bars included:

One 24"- White vertical grab bar
One 24" x 16" - White L-shaped grab bar
1¼" diameter white coated grab bars
with concealed mounting

Available on Madison™ 5 models

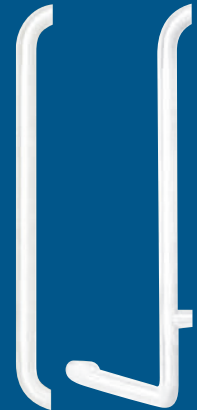

HYDROTHERAPY

Whirlpool Tub

Why not turn your bathroom into a relaxing sanctuary by adding a whirlpool system to your Mirolin® tub? High performance whirlpool jet technology and a $\frac{3}{4}$ hp pump ensure the ultimate whirlpool experience. With one simple turn, customize the desired water pressure and direction of flow with the fully adjustable whirlpool jets.

Whirlpool Heater

Getting out of the tub so soon because the water is getting cold? Add a factory-installed whirlpool heater to any whirlpool tub and enjoy a warmer, more relaxing bath for longer!

Backjet System

The system features a set of soothing jets to help ease sore back muscles and help you relax.



Factory Installed
Whirlpool Water Heater



Standard Water Jet
Polished Chrome or Brushed Nickel
Colours: White, Bone, Biscuit



SNAP-FIT® SYSTEM

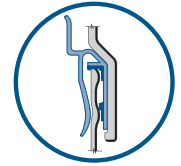

Snap-Fit® Maintenance
Free Overlap System



- 1 Easy Full Front Installation**
The full frontal installation of the Mirolin® Snap-Fit system allows for easy installation and requires no access to the rear of the unit.
- 2 Snap-Fit® System**
Snap-Fit makes installation easy as 1-2-3.
- 3 Overlap Joint**
The unique overlap joint provides an invisible seam that water cannot penetrate.

CAN. PATENT NO. 1240072

LATCH FIT SYSTEM

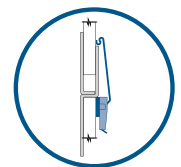

Latch Fit System
for Easy Assembly

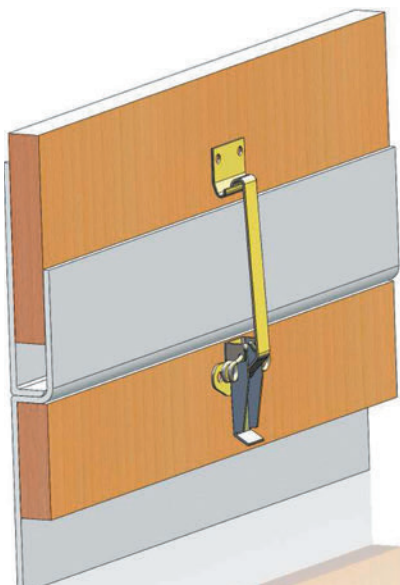

Easy Full Front Installation

Quick and easy to install without tools for a waterproof seal.



Available on the Tribeca and Sutton!

INTEGRAL TILE FLANGE

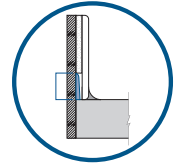

Integrated
Tile Flange

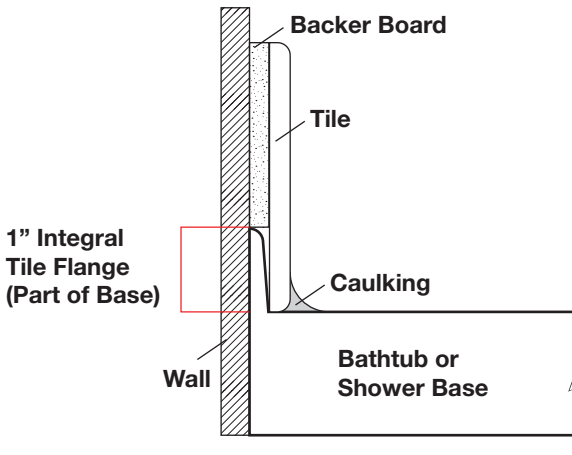

Integrated by Design

A one inch raised lip around the edge of the base which tiles can be placed over to provide a water tight barrier to protect against water damage and leaks, without compromising your bathroom design

Creates a Water Tight Seal!

ABOVE FLOOR ROUGH-IN

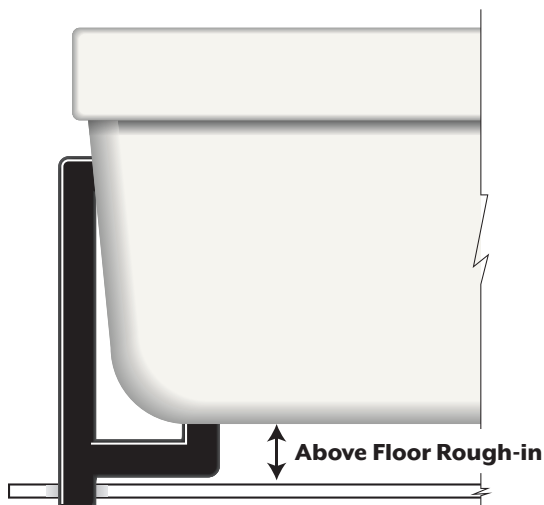

Minimum 2 3/4" clearance
bottom drain to floor

1 Easy Installation

A raised underside provides clearance between the tub basin and floor so the drainpipe can be easily routed without the expense of drain relocation

2 Versatile System

Perfect for concrete slab, renovations or new construction projects

TERMS AND CONDITIONS

PRICE, CONDITIONS OF ACCEPTANCE:

Orders are accepted subject to (1) prices in effect at the time of shipment and (2) change without notice. Published pricing schedule shows Suggested List Prices and such prices are subject to a trade discount as determined by Masco Canada Limited. The acceptance, shipment or delivery of any order is conditional upon approval of the Credit Department and upon only these Terms and Conditions, subject to specific agreement otherwise made in writing by Masco Canada Limited.

Masco Canada Limited may require satisfactory security for performance of buyer's obligations before making shipment on any order.

TERMS OF PAYMENT:

A two percent cash discount is allowed when invoice payments are received within 15 days of invoice date. Account balances unpaid after 30 days are subject to a 2% per month service charge, compounded monthly.

TAXES, FREIGHT AND SHIPPING:

All taxes extra. All shipments F.O.B. Masco Canada Limited's shipping point. If Buyer does not stipulate carrier and method of transportation at time of placing order, Masco Canada Limited will exercise discretion and ship by carrier of its choice at buyer's expense.

SHIPMENT SHORTAGES AND SHIPPING DAMAGE:

The packing slip is enclosed to assist Buyer in checking and receiving the Product. Masco Canada Limited is not responsible for shipping damage. Product should be carefully examined at time of receipt to ensure there is no shortage or damage. Buyer must file a claim with the carrier if shortage or damage is found at the time of delivery, with a notation on the freight bill noting the shortage and/or damage.

CANCELLATION:

Orders must be cancelled within a minimum of 24 hours of receipt and advised in writing.

RETURNED GOODS POLICY:

Product may not be returned for any reason without prior written consent of the Mirolin Sales Manager. Product cannot be returned for any reason other than manufacturing defect.

1. All products to be inspected by a Mirolin sales representative and a Return Goods Request form to be submitted for authorization.
2. Invoice and product serial numbers to be provided.
3. Only product in its original carton to be accepted back, and subject to inspection for concealed or freight damage. Any damage found is the responsibility of the Buyer and any freight claims are the responsibility of the returning account.
4. All items of made to order product made to buyer specifications and all discontinued product is non-returnable and not subject to cancellation by Buyer under any circumstance.
5. A repair cost may be applied against any repair required to bring a product back to 100% resalable condition.
6. Product that has been in Buyer's possession for longer than 12 months cannot be returned.
7. Only Mirolin stock items may be returned. To confirm if a product is a stock item please contact customer service.
8. A 20% restocking fee will be charged for all returns for any reason other than manufacturing defect or Masco Canada Limited shipping error. There will also be an additional \$15 packaging charge assessed.
9. Any product returned not meeting the standard of this policy will be denied and returned to the buyer freight collect.

LIMITED WARRANTY ON BATHING PRODUCTS:

This bathing product is warranted to the original consumer purchaser or commercial purchaser, as applicable, to be free from defects in material and workmanship for the applicable period specified below:

ALL ACRYLIC PRODUCTS

Ten (10) years from the date of purchase by the original consumer purchaser or, for commercial uses, one (1) year from the date of purchase.

ALL GLASS ENCLOSURES AND SHOWER DOORS

Five (5) years from the date of purchase by the original consumer purchaser or, for commercial users, one (1) year from the date of purchase.

ALL WHIRLPOOL COMPONENTS

Five (5) years from the date of purchase by the original consumer purchaser or, for commercial users, one (1) year from the date of purchase.

WHAT WE WILL DO

Masco Canada Limited, will repair or replace, free of charge, during the applicable warranty period (as described above), any item that proves defective in material and/or workmanship under normal installation, use and service. If repair or replacement is not practical, Masco Canada Limited may elect to refund the purchase price (the return of the product may be required at Masco Canada Limited's option). Masco Canada Limited reserves the right to discontinue and/or change models, colours and specifications in design on all products without notice and without incurring obligations. These are your exclusive remedies.

WHAT IS NOT COVERED

The following are not considered to be defects in material or workmanship and are not covered by this warranty:

1. Product variances \pm 6mm are within manufacturer's standard tolerance.
2. Pooling of water in the bathtub up to 10cm in diameter is deemed within manufacturer's standard tolerance. Bathtub must be installed level in all directions.
3. Bathtubs and showers may flex and creak when installed in accordance with manufacturer's specifications.

In addition, any labour charges incurred by the buyer to repair, replace, install or remove this product are not covered by this warranty. Masco Canada Limited shall not be liable for any damage to the product resulting from reasonable wear and tear, outdoor use, misuse (including use of the product for an unintended application), abuse, exposure to outdoor weather conditions due to improper storage prior to installation, neglect or improper or incorrectly performed installation, maintenance or repair, including failure to follow the applicable care and cleaning instructions. Masco Canada Limited recommends using a professional plumber for all installation and repair. We also recommend that you use genuine Mirolin replacements parts.

WHAT YOU MUST DO TO OBTAIN WARRANTY SERVICE OR REPLACEMENT PARTS

A warranty claim may be made, and replacement parts may be obtained by calling 1-800-MIROLIN (1-800-647-6546) or by contacting us by mail, e-mail, or online as follows (please include your model number, serial number and date of purchase):

Masco Canada Limited
350 South Edgeware Road
St. Thomas, Ontario
N5P 4L1
E-mail: support@mirolin.com
Online: www.mirolin.com

DO NOT USE CERTAIN CLEANING PRODUCTS

Cleaning products containing the following chemicals can cause this bathing product to crack or discolour and use of cleaning products containing these chemicals will void this warranty:

- Abrasives
- Acetone (including nail polish remover)
- Dry Cleaning Solutions
- Lacquer Thinners
- Gasoline
- Pine Oil

LIMITATION ON DURATION OF IMPLIED WARRANTIES

Note: Some states/ provinces (including Quebec) do not allow limitations on how long an implied warranty lasts, so the limitations below may not apply to you. TO THE EXTENT PERMITTED BY LAW, ANY IMPLIED WARRANTY, INCLUDING THE IMPLIED WARRANTIES OF MERCHANTABILITY AND OF FITNESS FOR A PARTICULAR PURPOSE, IS LIMITED TO THE STATUTORY PERIOD OR THE DURATION OF THIS WARRANTY, WHICHEVER IS SHORTER.

LIMITATION OF SPECIAL, INCIDENTAL, INDIRECT OR CONSEQUENTIAL DAMAGES

Note: Some states/ provinces (including Quebec) do not allow the exclusion or limitations of special, incidental, indirect or consequential damages, so the limitations and exclusions below may not apply to you. Notice to residents of the state of New Jersey: The provision of this warranty, including limitations, are intended to apply to the fullest extent permitted by the laws of the State of New Jersey. MASCO CANADA LIMITED SHALL NOT BE LIABLE FOR ANY SPECIAL INCIDENTAL OR CONSEQUENTIAL DAMAGES (INCLUDING LABOUR CHARGES TO REPAIR, REPLACE, INSTALL OR REMOVE THIS PRODUCT), WHETHER ARISING OUT OF BREACH OF ANY EXPRESS OR IMPLIED WARRANTY, BREACH OF CONTRACT, TORT, OR OTHERWISE. MASCO CANADA LIMITED SHALL NOT BE LIABLE FOR ANY DAMAGE TO THE PRODUCT RESULTING FROM REASONABLE WEAR AND TEAR, OUTDOOR USE, MISUSE (INCLUDING USE OF THE PRODUCT FOR AN UNINTENDED APPLICATION), ABUSE, NEGLIGENCE OR IMPROPER OR INCORRECTLY PERFORMED INSTALLATION, MAINTENANCE OR REPAIR, INCLUDING FAILURE TO FOLLOW THE APPLICABLE CARE AND CLEANING INSTRUCTIONS.

Masco Canada Limited will not be liable for any delay or failure to perform if such delay or failure to perform is caused by circumstances beyond its reasonable control, including without limitation, as to Masco Canada Limited and its facilities and products and the facilities, materials and products of its suppliers, acts of God, orders, directions or acts of any public authority, riots or other public disturbances, epidemic, pandemic, labor shortages or disputes of any kind, financial constraints, power shortages or failures, Buyer's failure to provide required information or adequate containers, changes in the cost or availability of raw materials, components or services based on market conditions, contract dispute, or Masco Canada Limited's or its suppliers' actions. During any such delay or failure to perform by Masco Canada Limited, Masco Canada Limited's obligations under these Terms and Conditions shall be suspended and Masco Canada Limited will not have any obligation to provide Buyer with the Product from other sources or to pay or reimburse Buyer for any additional costs to Buyer of obtaining substitute products. Masco Canada Limited may, during any period of shortage due to any of the above circumstances, allocate its available supply of products among its customers in any manner that it deems fair and reasonable in its sole discretion.

ADDITIONAL RIGHTS

This warranty gives you special legal rights, and you may also have other rights which vary from state/province to state/province.

This is Masco Canada Limited exclusive written warranty and the warranty is not transferable.

If you have any questions or concerns regarding technical support, installation or our warranty, please contact us as provided above or visit our website www.mirolin.com



Our Commitment to the Environment

Masco Canada Limited is deeply committed to being a responsible corporate citizen. We promote on-going conscientious practices in both manufacturing and in day-to-day operations. Masco Canada Limited is constantly looking for new ways to produce less manufacturing waste. We operate our manufacturing facilities as efficiently as possible with conservation of energy and the environment in mind.



A MASCO COMPANY

MASCO CANADA LIMITED
350 SOUTH EDGEWARE RD
ST. THOMAS, ON N5P 4L1
1 800 760 3388

mirolin.com
support@mirolin.com

©2021 MASCO CANADA LIMITED
MKT-21-028E