

FEATURES:

- Brass construction
- Single Control cycles from Cold to Hot
- High temperature Limit Stop
- 20 psi minimum operating pressure, 125 psi maximum
- Flow Rate
- 5.5 gpm @ 45 psi

APPROVAL:

- ASME A112.18.1 / CSA B125.1
- ASSE 1016 / ASME A112.1016 / CSA B125.16

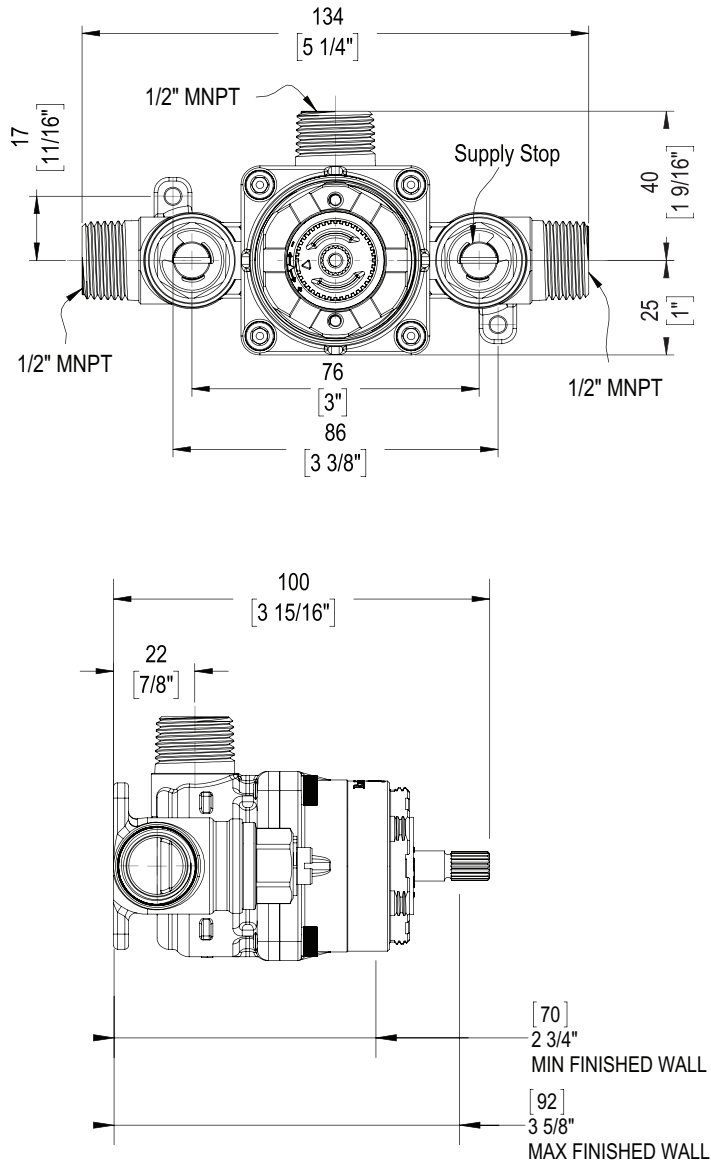

4YR100

CONTACT US:

If you need assistance with installation, replacement parts or have any questions regarding your Rubinet product, please call a Customer Service representative at: 905-851-6781 toll free 1-800-461-5901 or visit www.rubinet.com

170726

ASSEMBLY INSTRUCTION

4YR100

VALVE ONLY PRESSURE BALANCE WITH STOPS ROUGH-IN

REMOVAL OF FIXTURE:

Always turn the water supply off before removing the existing fixture or disassembling a valve. Open all fixture handles to relieve water pressure and to ensure that the water has been successfully turned off.

1

FINISHED WALL

* MUST REFER TO THE MAXIMUM AND MINIMUM WALL LIMIT GUIDE.

Minimum Finished Wall Limit

Maximum Finished Wall Limit

90°

Rough-in must be positioned square to the wall for proper trim installation.

[152]
Ø 6" hole size

Protective Cover
Refer to the protective cover (mounting guide) markings for proper installation depth. This cover must remain in place when plastering and/or tiling etc.

Stop close

Stop open

Anchor using ears on the valve body.

Pipe clamp recommended.

INSTALLATION PROBLEMS

If water continuously drips from the spout or shower head or there is reduced water flow:

- Turn off the water supply at the stops.
- Remove the cartridge.
- Check for debris in the valve body.
- Inspect o-rings for damage.
- Re-grease with silicone-based grease only.
- Re-install the cartridge

2

SETTING HOT LIMIT STOP

Remove the grey adjustment ring.

Reorient the ring in counter-clockwise.

stop tab

To set desired outlet temperature, pry out the grey adjustment ring, rotate cartridge stem counter clockwise until the desired temperature is reached. Now re-insert grey adjustment ring to align the grey and blue tabs as shown in graphics.

BACK TO BACK INSTALLATION

cartridge

hex nut

* locating holes

Regular (upper)

Reverse (lower)

pin

Loosen hex nut to remove the cartridge from valve cavity. Aligning the pin with lower locating hole inside the valve cavity, re-insert the cartridge and press it firmly to ensure the pin is properly placed. Reassemble the hex nut.