

No	PartNo	PartName	quantity	Level	Sub-part No
3	K2273458	base holder part	1	1	K1555385,K1223739,K1555378,K1555381,K1470426,K1222824,K1465670
4	K1555381	connecting rod	1	2	
5	K1555378	vertical louver	2	2	
6	K1555385	connecting rod	1	2	
23	K1222824	axis sheath	2	2	
37	K1470426	Water pipe parts	1	2	
11	K1465670	baffle	1	2	
10	K1223739	bearing	1	2	
2	K1906600	installation plate assembly	1	1	
7	K1555387	connecting rod	1	1	
8	K1557807	level vane	1	1	
9	K2092899	cross-flow fan blade	1	1	
1	K1984201	baffle	1	1	
12	K2000575	Refrigeration system	1	1	
44	K2304527	shell assembly	1	1	K1851515,K1849430,K1849432,K2007194
13	K1849430	ornamental part	1	2	
14	K2007194	shell parts	1	2	
15	K1849432	ornamental part	1	2	
18	K1851515	decorative strip	1	2	
16	K1803359	Panel pattern	1	1	
17	K1875496	display assembly	1	1	
24	K1555386	motor guard	1	1	
20	K1838324	DC motor	1	1	
21	K2091436	motor cover	1	1	
22	K1260259	stepper motor	1	1	
19	K2091423	motor guard	1	1	
25	K1468408	stepper motor	1	1	
26	K2186246	wireless remote control switch	1	1	
27	K1840039	electric box cover	1	1	
28	K1387643	Temperature sensor	1	1	
29	K1471151	Temperature sensor	1	1	
30	K1465763	electric box cover	1	1	
31	K1839902	clamp	1	1	
32	K1852126	terminal Block	1	1	
33	K1465761	electric box plate	1	1	
34	K2196727	indoor electrical control board ASS'Y	1	1	
35	K1868909	electric box	1	1	
36	K1465762	electric box plate	1	1	
38	K1506312	Filter net	2	1	
39	K1803299	carton pattern	1	1	
40	K1325322	EPE bag	1	1	
41	K2144940	WIFI module	1	1	
43	K1860138	remote control holder	1	1	

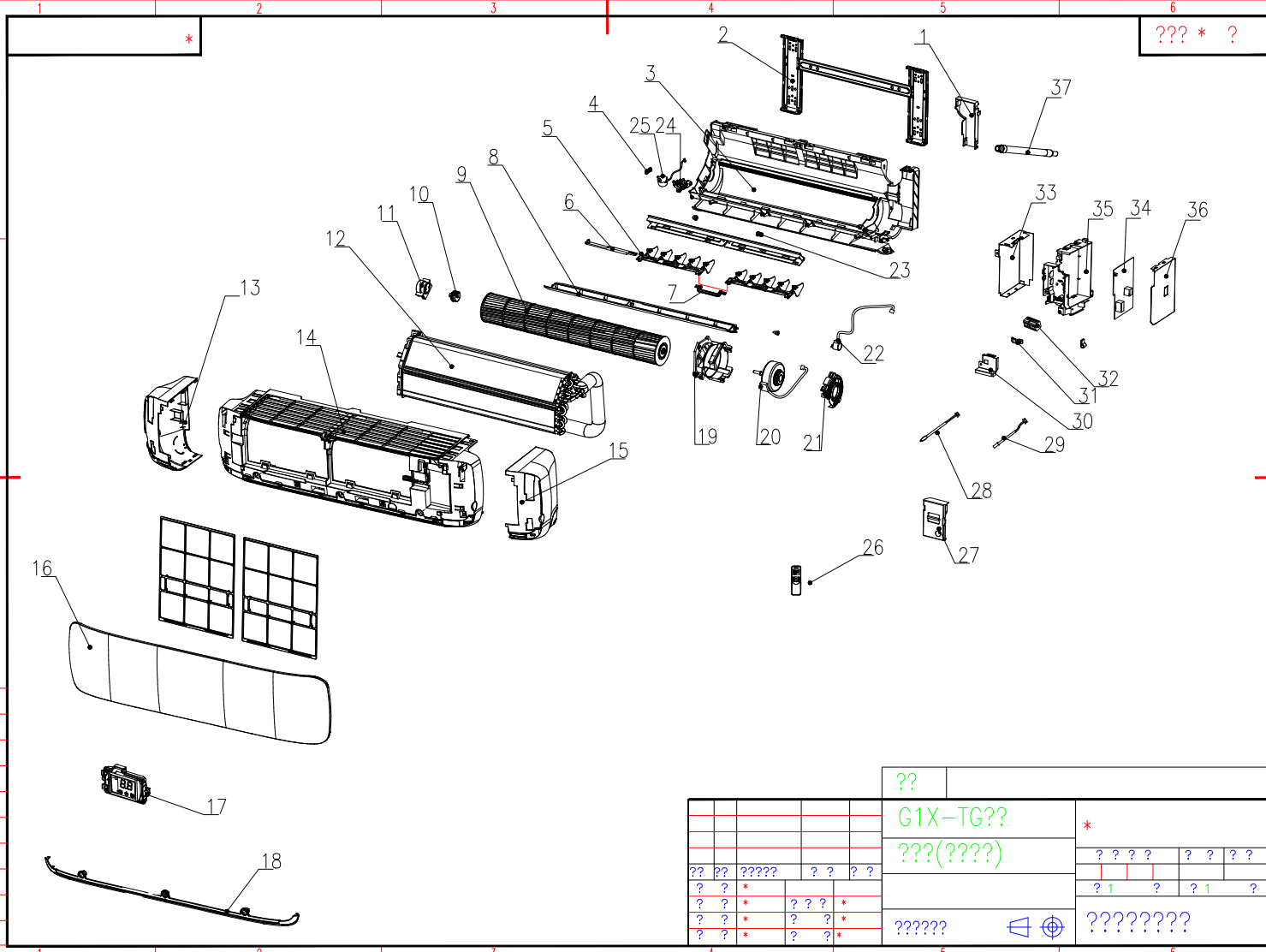

A

B

C

?(?)????

?????

????

????

? ?

A

B

C

D