



Woven tote bag

OS 300 GSM

Description

Top edge double folded for strength and clean finish  
Long handles with reinforced cross stitch  
Shaping seam at bottom to create volume

Composition

Shell - Canvas  
80% Cotton - Recycled, 20% Polyester - Recycled - 300.0 GSM  
Fabric washed

Care instruction

Wash similar colours together, do not iron on print, wash and iron inside out.



Country of origin

Weaving : Bangladesh  
Dyeing : Bangladesh  
Assembly : Bangladesh

Whites



New  
White  
C001



Natural  
C007

Colors



Black  
C002



Midnight  
Blue  
C591

Essential Heathers



Heather  
Grey  
C250

Size Guide

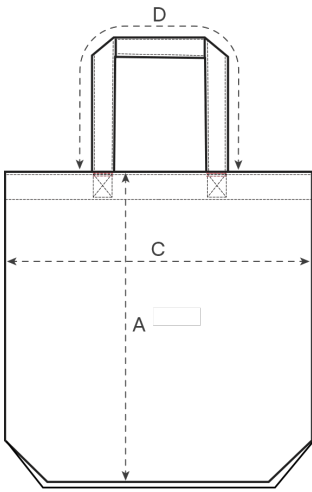

Front

Measurement in cm	OS
A - Height	39
C - Width	37
D - Strap Length	65

Packing

Sizes	OS
Pieces / bag	5
Pieces / box	100